

JAYCO®

ENGINEERING (INDIA)



PLUMMER BLOCKS & PRECISION BEARING UNITS



INTRODUCTION



JAYCO ENGINEERING (INDIA) IS ONE OF THE LEADING MANUFACTURERS OF PLUMMER BLOCK HOUSINGS IN INDIA AS JAYCO BRAND BEARING HOUSINGS. WE HAVE COME A LONG WAY CONTRIBUTING EFFECTIVELY TO THE DEVELOPMENT OF HOUSINGS SOLUTION WHICH TODAY HAS MADE US THE INDUSTRY LEADER IN THIS FIELD ACROSS THE COUNTRY. JAYCO IS WELL RECOGNIZED AND WIDELY USED ACROSS ALL SECTORS OF THE INDUSTRY AND EVEN SOME OF THE LARGEST COMPANIES TODAY DEPEND ON US FOR THEIR PLUMMER BLOCK REQUIREMENT. STRONG CUSTOMER FOCUS APPROACH AND CONSTANT QUEST FOR TOP-CLASS QUALITY HAVE ENABLED JAYCO TO ATTAIN AND SUSTAIN LEADERSHIP POSITION OVER YEARS.



JAYCO ENGINEERING(INDIA)

DESIGN AND MANUFACTURE QUALITY *BEARING UNITS, PLUMMER BLOCKS* AND TO SUIT ANY APPLICATION. OUR RANGE OF PLUMMER BLOCK , BEARING HOUSINGS CAN BE MADE IN ANY MATERIAL, INCLUDING CAST IRON, SG CAST IRON, CAST STEEL AND STAINLESS STEEL.

OUR IN-HOUSE CAD TEAM ARE AT HAND TO PROVIDE SOLUTIONS TO ANY OF YOUR BEARING NEEDS. JAYCO IS A LEADING INDIAN SUPPLIER TO THE BEARING INDUSTRY AND HAVE NO PROBLEM IN MANUFACTURING HEAVY DUTY AND SPECIAL BEARING HOUSINGS.

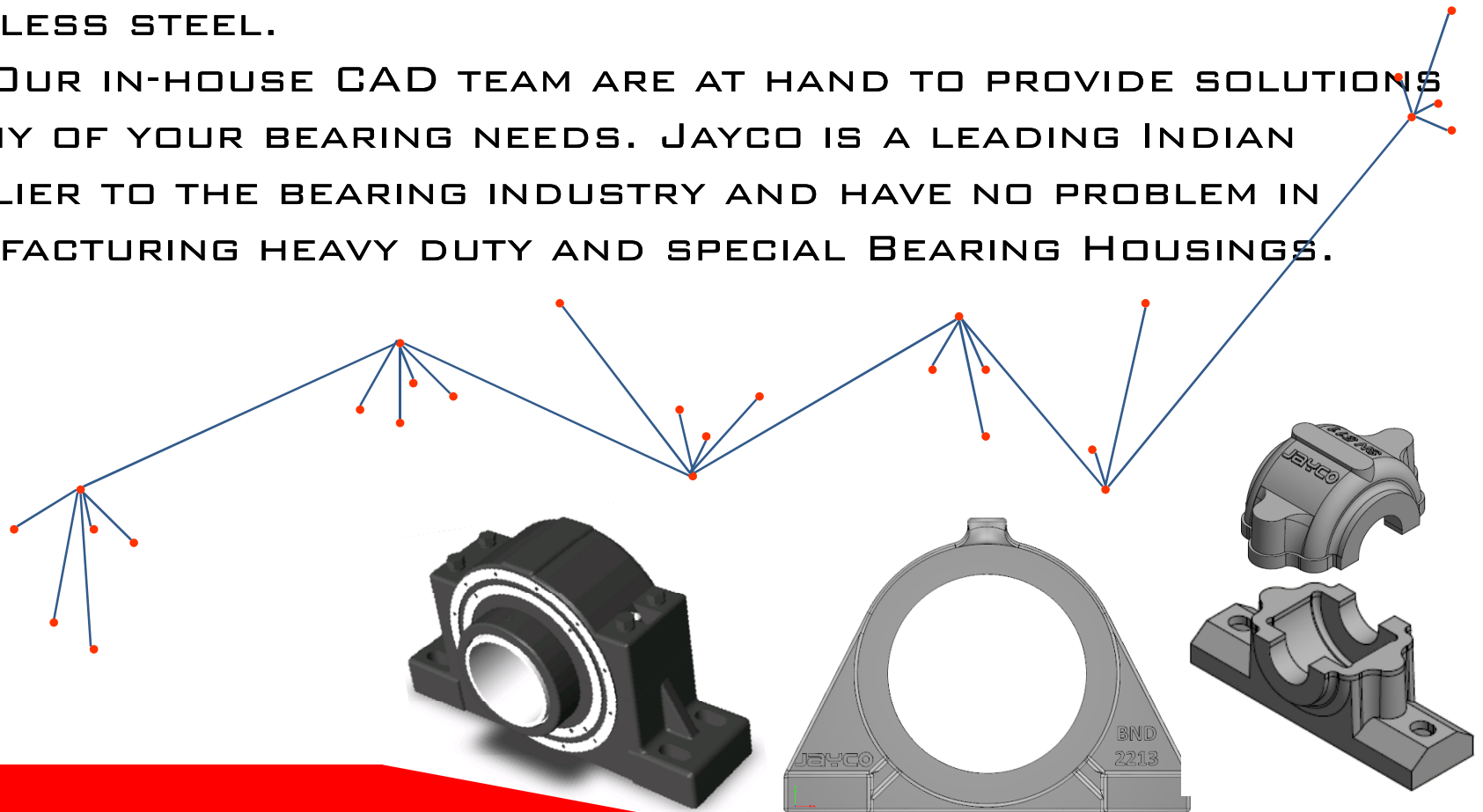

MISSION

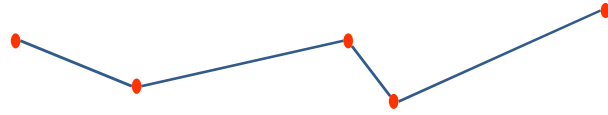

THE COMPANY HAS BUILT AN OUTSTANDING REPUTATION FOR QUALITY AND RELIABILITY AND INCLUDES MOST OF THE WORLDS LEADING BEARING MANUFACTURERS IN THEIR LIST OF SATISFIED CUSTOMERS. THESE AND ALL THE INDIA BEARING DISTRIBUTORS ACCOUNT FOR THE MAJOR PORTION OF BUSINESS AND IN RECENT YEARS THE EXPORT ARM OF THE BUSINESS HAS INCREASED DRAMATICALLY AND JAYCO BEARINGS AND HOUSINGS CAN NOW BE FOUND AROUND THE GLOBE. JAYCO'S STRENGTH LIES IN ITS ABILITY TO UNDERSTAND THEIR CUSTOMER'S NEEDS, TRANSLATE THEM TO DRAWINGS AND PRODUCE THE GOODS OF THE RIGHT QUALITY – ON TIME. LATEST TECHNOLOGY IS ALSO APPLIED AND TRAINING CONDUCTED TO RECOGNIZED STANDARDS TO ENSURE THAT THE COMPANY MAINTAINS ITS COMPETITIVE ADVANTAGE.

QUALITY

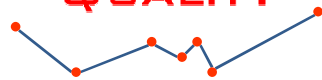

THE ENTIRE RANGE FOR OF OUR PLUMMER BLOCK , BEARING HOUSINGS, WE FOLLOW HIGHEST STANDARDS TO DELIVER PRODUCTS OF INTERNATIONAL QUALITY. WITH THIS STRINGENT QUALITY CONTROL IN PLAGE, WE ENSURE AND PROVIDE THE HIGHEST STANDARDS OF QUALITY.



JAYCO – THE EARLY DAYS

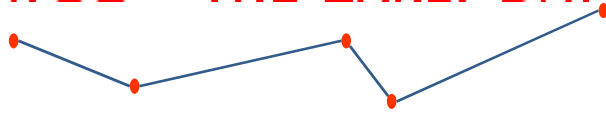

JAYCO WAS FOUNDED IN 2013 BY MR. SURESH PRAJAPATI. IN ADDITION TO A STRONG INDIAN CUSTOMER BASE, MR. SURESH IS ENTHUSIASTIC AND EAGER TO PROMOTE THE COMPANY'S PRODUCTS ON A WORLDWIDE SCALE. RECENTLY, WE HAVE BEEN SUCCESSFUL IN SECURING BEARING HOUSING BUSINESS FROM ALL CORNERS OF THE GLOBE. SPECIALIZING IN THE DESIGN AND MANUFACTURE OF QUALITY BEARING HOUSINGS. JAYCO PRIDE THEMSELVES ON AN IMMEDIATE AND DEDICATED RESPONSE TO STANDARD AND SPECIAL BEARING HOUSING SOLUTIONS. JAYCO OFFER A FULL DESIGN SERVICE TO ANY OF ITS CUSTOMERS WHO HAVE NON STANDARD REQUIREMENTS. WE CAN FOLLOW ON THE BEST MATERIAL AND MANUFACTURING PROCESS FOR YOUR REQUIREMENT. BACKED BY A COMMITTED AND SKILLED WORKFORCE, JAYCO HAVE DEVELOPED LONG-TERM WORKING RELATIONSHIPS WITH ALL OF THEIR CUSTOMERS.



MAJOR-WORKING SECTORS

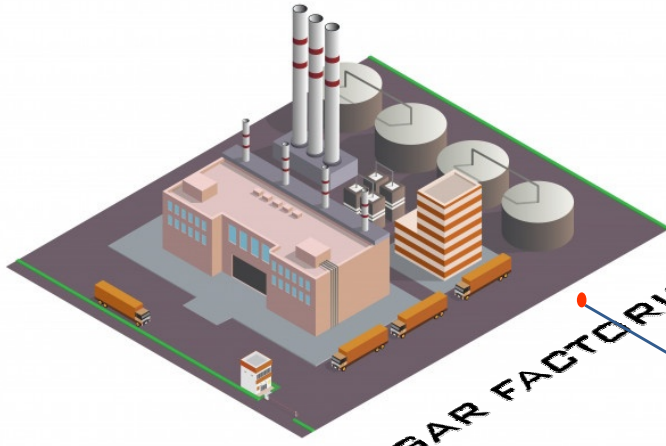

SUGAR FACTORIES

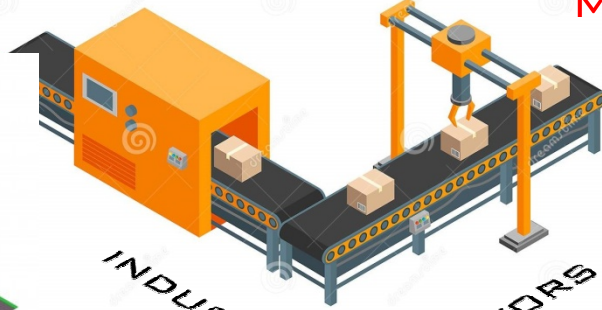

INDUSTRIAL CONVEYORS



POWER PLANTS



CEMENT PLANTS



MINES AND MINERALS



STEEL PLANTS



OTHER- GENERAL SECTORS

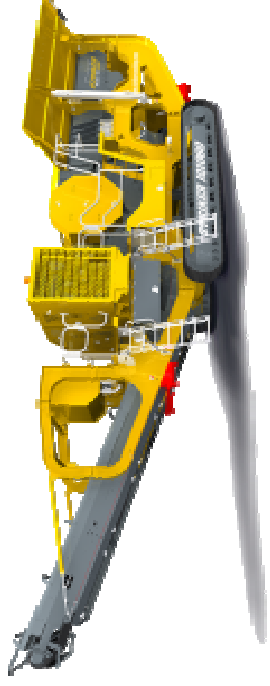

CRUSHER / CONVEYOR SYSTEMS

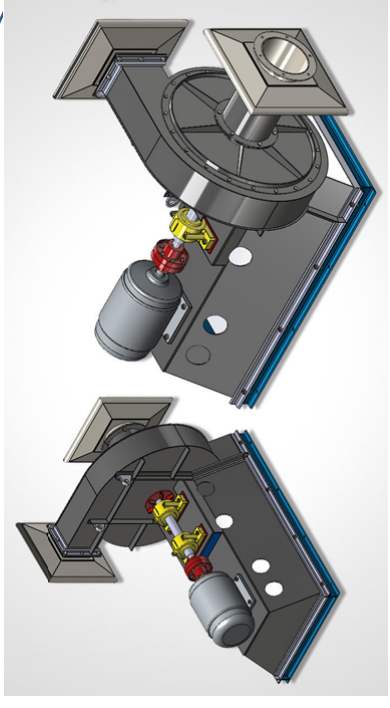

I D FANS / BLOWERS

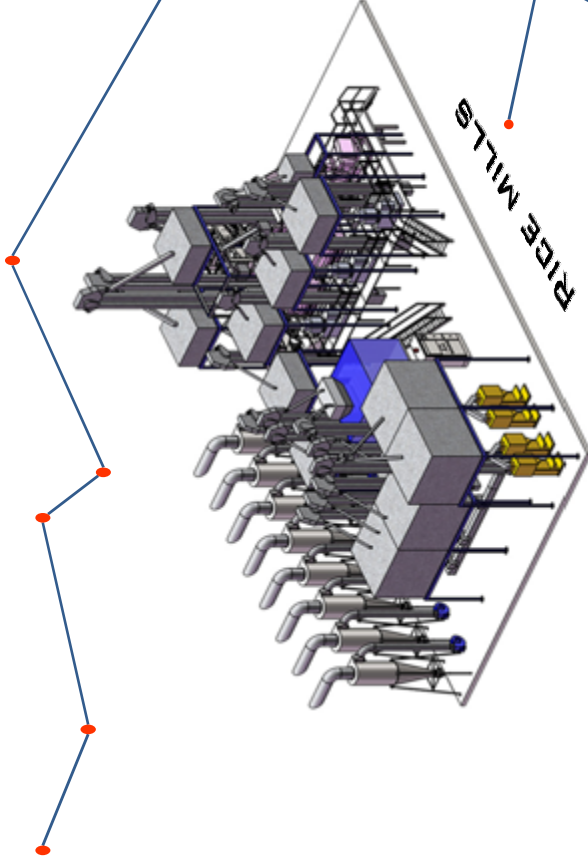

RICE MILLS

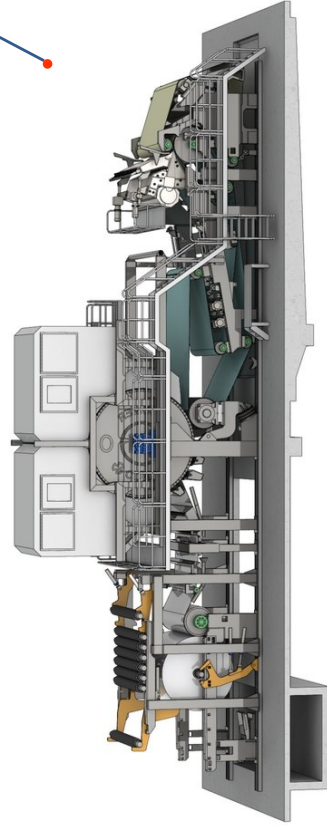

PAPER & BOARD PLANT

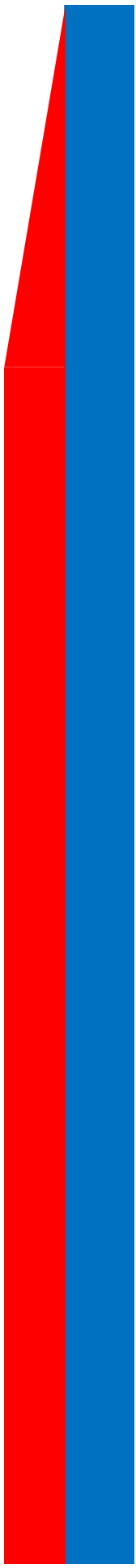

PRODUCTIVITY AT - JAYCO



CAD-DESIGN



PATTERN CRAFTING



CASTING PROCESS



DRILLING PROCESS



MACHENING PROCESS



CNC MACHENING PROCESS



INSPECTION

THE LATEST STATE-OF-THE-ART CAD/CAM SOFTWARE ENABLES JAYCO TO DESIGN AND MANUFACTURE PRODUCTS TO THE HIGHEST STANDARDS.

WE HAVE A COMPREHENSIVE RANGE OF MACHINE TOOLS TO PERFORM A WIDE SELECTION OF OPERATIONS AND A POLICY OF CONTINUAL IMPROVEMENT. JAYCO HAVE A NEW SUPER TURNING CNC MACHINE WHICH WILL BE ABLE TO DEAL WITH DIAMETERS UP TO 300 MM. IT WILL KEEP US IN THE FOREFRONT OF ENGINEERING EXPECTATIONS AND SATISFY DEMANDING APPLICATIONS.

PRODUCT RANGES

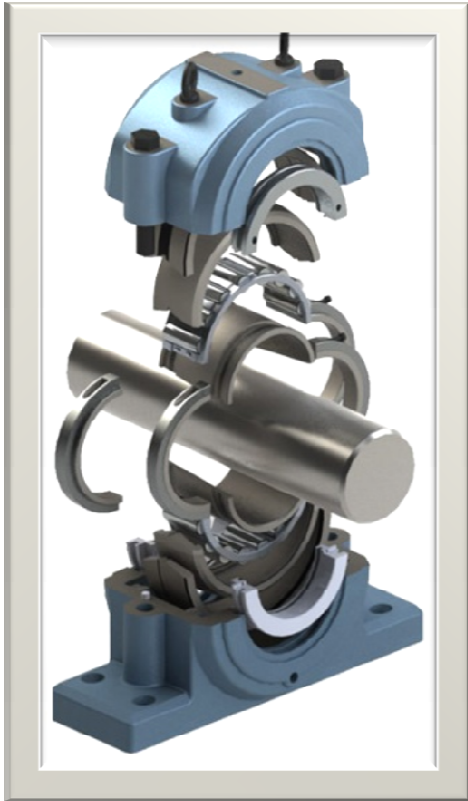

BEARING
HOUSINGS



PLUMMER BLOCKS



BEARING ACCESSORIES

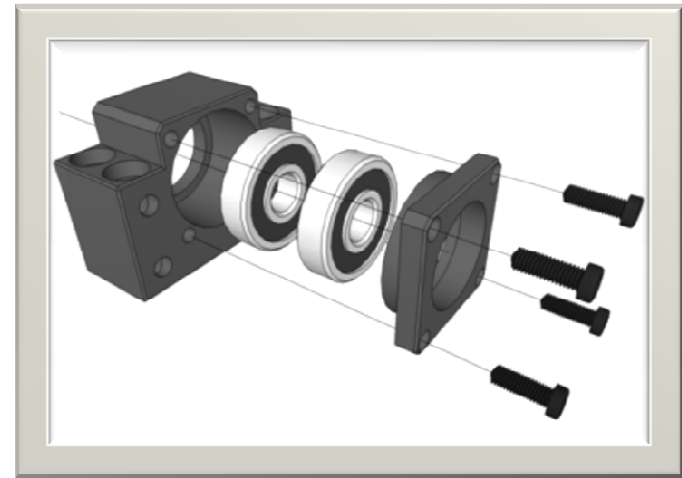

CUSTOMIZED HOUSINGS



PLUMMER BLOCKS

'S' SERIES - 500 & 600



SUITABLE BEARING
S-500 / 1200, 6200, 2200
S-600 / 1300, 6300, 2300

SHAFT DIA: 20 TO 140 MM

SEAL

FELT

LUBRICATION

GREASE

TYPE

HORIZONTAL SPLIT TYPE WITH
TWO MOUNTING HOLES OF OVAL
SHAPE.

OPTIONAL FEATURES
AVAILABLE ON REQUEST

TWO FOUNDATION HOLE AT BASE
•END COVER FOR CLOSED END
•MATERIAL: C.S. GR. 280/520,
IS 1030 FOR SEVER LOAD.
•SOLID BASE FOR HEAVY LOAD
APPLICATION ON REQUEST

SN - SERIES PLUMMER BLOCK



500 - 600 SERIES

SHAFT DIA :- 20 TO 140 MM	
MATERIAL	CAST IRON
MFG. STANDARD	IS 14347 - 1996 ISO 113 - 1994
SEAL	FELT
LUBRICATION	GREASE
TYPE	HORIZONTAL SPLIT TYPE WITH TWO MOUNTING HOLES OF OVAL SHAPE.
APPLICATION	ECONOMIC REPLACEABLE UNITS, NORMALLY REQUIRE LITTLE MAINTENANCE. USED IN GENERAL INDUSTRIAL APPLICATION HAVING MODERATE LOAD & SPEED IN RELATIVELY LESS HOSTILE SURROUNDING.
OPTIONAL FEATURES AVAILABLE ON REQUEST	<ul style="list-style-type: none"> •FOUR FOUNDATION BOLT HOLE AT BASE •FOUR CAP BOLTS •LABYRINTH SEAL •END COVER FOR CLOSED END •MATERIAL-C.S. GR.280/520, IS 1030 FOR SEVER LOAD •SOLID BASE FOR HEAVY LOAD APPLICATION

FOR BEARING HOUSINGS WHERE STRENGTH OF GREY CAST IRON MATERIAL IS STILL INADEQUATE, THESE HOUSINGS CAN ALSO BE SUPPLIED IN CAST STEEL OR S.G.IRON . SUCH BEARING HOUSINGS CAN SUPPORT APPROXIMATELY TWICE THE LOAD PERMITTED FOR GREY CAST IRON HOUSINGS. THESE BEARING HOUSINGS ARE DIMENSIONALLY INTERCHANGEABLE AND SUITABLE TO BEARINGS OF INTERNATIONAL STANDARD . JAYCO SN, SNA & SNH TYPE HOUSINGS ARE DESIGNED INTERCHANGEABLE FOR SAME BEARING SIZE AND MOUNTING DIMENSIONS. ALL HOUSINGS ARE SUPPLIED AS NON LOCATED TYPE. FOR LOCATING TYPE, SUITABLE LOCATING RING-FRB TO BE ORDERED SEPARATELY.



SN HOUSING FOR BEARINGS WITH CYLINDRICAL BORE

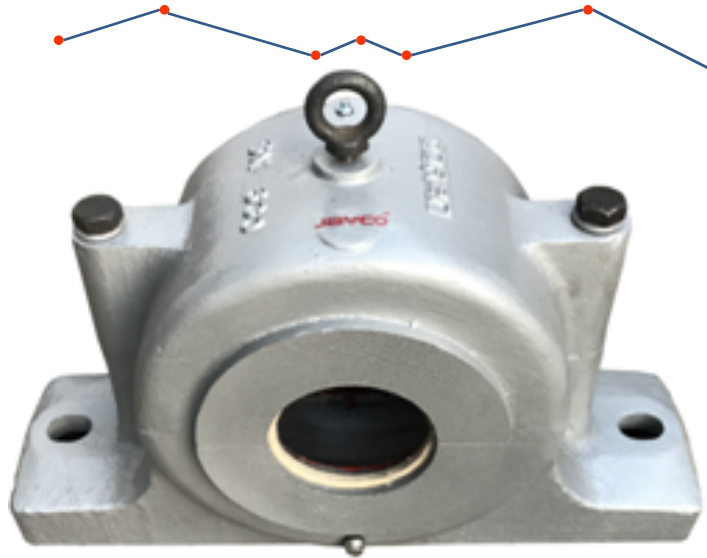

200 - 300 SERIES

SHAFT DIA :- 25 TO 160 MM	
MATERIAL	CAST IRON
MFG. STANDARD	IS 14347 - 1996 ISO 113 - 1994
SEAL	FELT
LUBRICATION	GREASE
TYPE	HORIZONTAL SPLIT TYPE WITH TWO MOUNTING HOLES OF OVAL SHAPE
APPLICATION	ECONOMIC REPLACEABLE UNITS, NORMALLY REQUIRE LITTLE MAINTENANCE. USED IN GENERAL INDUSTRIAL APPLICATION HAVING MODERATE LOAD & SPEED IN RELATIVELY LESS HOSTILE SURROUNDING.
OPTIONAL FEATURES AVAILABLE ON REQUEST	<ul style="list-style-type: none"> •FOUR FOUNDATION BOLT HOLES AT BASE •FOUR CAP BOLTS •LABYRINTH SEAL •END COVER FOR CLOSED END TYPE. •MATERIAL-C.S. GR.280/520, IS 1030 FOR SEVER LOAD •SOLID BASE FOR HEAVY LOAD APPLICATION

FOR BEARING HOUSINGS WHERE STRENGTH OF GREY CAST IRON MATERIAL IS STILL INADEQUATE, THESE HOUSINGS CAN ALSO BE SUPPLIED IN CAST STEEL OR S.G.IRON . SUCH BEARING HOUSINGS CAN SUPPORT APPROXIMATELY TWICE THE LOAD PERMITTED FOR GREY CAST IRON HOUSINGS. THESE BEARING HOUSINGS ARE DIMENSIONALLY INTER CHANGEABLE AND SUITABLE TO BEARINGS OF INTERNATIONAL STANDARD. JAYCO SN, SNA & SNH TYPE HOUSINGS ARE DESIGNED INTERCHANGEABLE FOR SAME BEARING SIZE AND MOUNTING DIMENSIONS. ALL HOUSINGS ARE SUPPLIED AS NON LOCATED TYPE. FOR LOCATING TYPE, SUITABLE LOCATING RING-FRB TO BE ORDERED SEPARATELY

SN 30 - 31 HOUSINGS FOR SPHERICAL ROLLER BEARINGS WITH ADAPTER SLEEVE FOR PLAIN CYLINDRICAL SHAFTS



3000 - 3100 SERIES

SHAFT DIA :- 110 TO 260 MM	
MATERIAL	CAST IRON
MFG. STANDARD	IS 14347 - 1996 ISO 113 - 1994
SEAL	FELT
LUBRICATION	GREASE
TYPE	HORIZONTAL SPLIT TYPE WITH TWO MOUNTING HOLES OF OVAL SHAPE.
APPLICATION	COMBINED FEATURES OF SNA AND SNH TYPE GIVE THIS HOUSING IMPROVED DESIGN AND ALLOW INCREASED LOAD CARRYING CAPACITY.
OPTIONAL FEATURES AVAILABLE ON REQUEST	<ul style="list-style-type: none"> •FOUR FOUNDATION BOLT HOLES AT BASE •ADDITIONAL V-RING SEAL. •LABYRINTH SEAL •END COVER FOR CLOSED END TYPE. •SOLID BASE FOR HEAVY LOAD APPLICATION. •MATERIAL : CAST STEEL •DRAIN PLUG

FOR BEARING HOUSINGS WHERE STRENGTH OF GREY CAST IRON MATERIAL IS STILL INADEQUATE, THESE HOUSINGS CAN ALSO BE SUPPLIED IN CAST STEEL OR S.G. IRON. SUCH BEARING HOUSINGS CAN SUPPORT APPROXIMATELY TWICE THE LOAD PERMITTED FOR GREY CAST IRON HOUSINGS. THESE BEARING HOUSINGS ARE DIMENSIONALLY INTER CHANGEABLE AND SUITABLE TO BEARINGS OF INTERNATIONAL MAKE.



SNA BEARING HOUSING FOR BEARINGS WITH ADAPTER SLEEVE

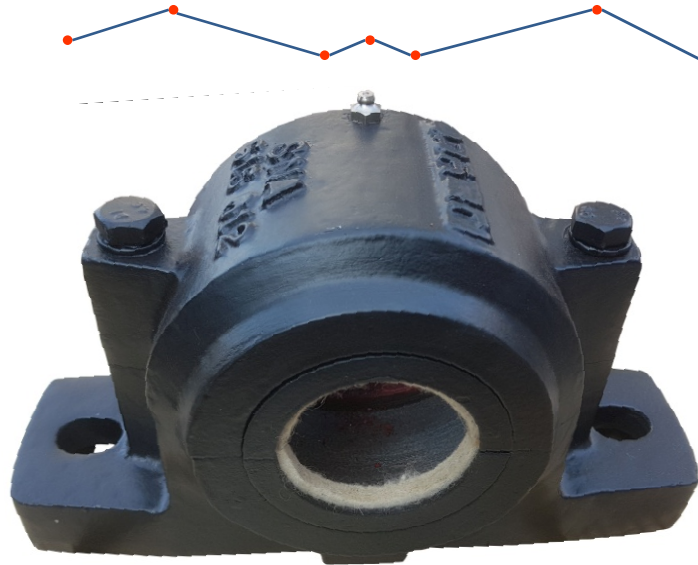

500 – 600 SERIES

SHAFT DIA :- 25 TO 140 MM	
MATERIAL	CAST IRON
MFG. STANDARD	IS 14347 - 1996 ISO 113 - 1994
SEAL	TG (FELT IN ALUMINUM HALF RINGS)
LUBRICATION	GREASE OR OIL
TYPE	HORIZONTAL SPLIT TYPE WITH TWO MOUNTING HOLES OF OVAL SHAPE.
APPLICATION	RELATIVELY HIGHER LOAD APPLICATION LIKE IN PAPER M/C, MINING, CONSTRUCTION AND CONVEYOR. BETTER SEALING ARRANGEMENT PERMITS DUSTY AND TEMPERATURE SURROUNDINGS.
OPTIONAL FEATURES AVAILABLE ON REQUEST	<ul style="list-style-type: none"> •FOUR FOUNDATION BOLT HOLES AT BASE •V SEAL (TA),DOUBLE LIP SEAL (TG), LABYRINTH SEAL(TS) •END COVER FOR CLOSED END TYPE •MATERIAL-C.S. GR.280/520, IS 1030 & S.G. IRON •SOLID BASE FOR HEAVY LOAD APPLICATION •DRAIN PLUG

FOR BEARING HOUSINGS WHERE STRENGTH OF GREY CAST IRON MATERIAL IS STILL INADEQUATE, THESE HOUSINGS AN ALSO BE SUPPLIED IN CAST STEEL OR S.G. IRON . SUCH BEARING HOUSINGS CAN SUPPORT APPROXIMATELY TWICE THE LOAD PERMITTED FOR GREY CAST IRON HOUSINGS. THESE BEARING HOUSINGS ARE DIMENSIONALLY INTER CHANGEABLE AND SUITABLE TO BEARINGS OF INTERNATIONAL MAKE . JAYCO SN, SNA & SNH TYPE HOUSINGS ARE DESIGNED INTERCHANGEABLE FOR SAME BEARING SIZE AND MOUNTING DIMENSIONS. ALL HOUSINGS ARE SUPPLIED AS NON LOCATED TYPE. FOR LOCATING TYPE, SUITABLE LOCATING RING-FRB TO BE ORDERED SEPARATELY

SNA SERIES BEARING HOUSING FOR BEARINGS WITH CYLINDRICAL BORE



200 - 300 SERIES

SHAFT DIA :- 25 TO 140 MM

MATERIAL	CAST IRON
MFG. STANDARD	IS 14347 - 1996 ISO 113 - 1994
SEAL	TG (FELT IN ALUMINUM HALF RINGS)
LUBRICATION	GREASE OR OIL
TYPE	HORIZONTAL SPLIT TYPE WITH TWO MOUNTING HOLES OF OVAL SHAPE.
APPLICATION	RELATIVELY HIGHER LOAD APPLICATION LIKE IN PAPER M/C, MINING, CONSTRUCTION AND CONVEYOR. BETTER SEALING ARRANGEMENT PERMITS DUSTY AND TEMPERATURE SURROUNDINGS.
OPTIONAL FEATURES AVAILABLE ON REQUEST	<ul style="list-style-type: none"> •FOUR FOUNDATION BOLT HOLES AT BASE •V SEAL (TA),DOUBLE LIP SEAL (TG), LABYRINTH SEAL(TS) •END COVER FOR CLOSED END TYPE •MATERIAL-C.S. GR.280/520, IS 1030 & S.G. IRON •SOLID BASE FOR HEAVY LOAD APPLICATION •DRAIN PLUG

FOR BEARING HOUSINGS WHERE STRENGTH OF GREY CAST IRON MATERIAL IS STILL INADEQUATE, THESE HOUSINGS AN ALSO BE SUPPLIED IN CAST STEEL OR S.G. IRON. SUCH BEARING HOUSINGS CAN SUPPORT APPROXIMATELY TWICE THE LOAD PERMITTED FOR GREY CAST IRON HOUSINGS. THESE BEARING HOUSINGS ARE DIMENSIONALLY INTER CHANGEABLE AND SUITABLE TO BEARINGS OF INTERNATIONAL MAKE . JAYCO SN, SNA & SNH TYPE HOUSINGS ARE DESIGNED INTERCHANGEABLE FOR SAME BEARING SIZE AND MOUNTING DIMENSIONS. ALL HOUSINGS ARE SUPPLIED AS NON LOCATED TYPE. FOR LOCATING TYPE, SUITABLE LOCATING RING-FRB TO BE ORDERED SEPARATELY

SNH BEARING HOUSING FOR BEARINGS WITH ADAPTER SLEEVE



500 - 600 SERIES

SHAFT DIA :- 25 TO 140 MM	
MATERIAL	CAST IRON
MFG. STANDARD	IS 14347 - 1996 ISO 113 - 1994
SEAL	TC (FELT IN ALUMINUM HALF RINGS)
LUBRICATION	GREASE OR OIL
TYPE	HORIZONTAL SPLIT TYPE WITH TWO MOUNTING HOLES OF OVAL SHAPE.
APPLICATION	RELATIVELY HIGHER LOAD APPLICATION LIKE IN PAPER M/C, MINING, CONSTRUCTION AND CONVEYOR. BETTER SEALING ARRANGEMENT PERMITS DUSTY AND TEMPERATURE SURROUNDINGS.
OPTIONAL FEATURES AVAILABLE ON REQUEST	<ul style="list-style-type: none"> •FOUR FOUNDATION BOLT HOLES AT BASE •V SEAL (TA),DOUBLE LIP SEAL (TG), LABYRINTH SEAL(TS) •END COVER FOR CLOSED END TYPE •MATERIAL-C.S. GR.280/520, IS 1030 & S.G. IRON •SOLID BASE FOR HEAVY LOAD APPLICATION •DRAIN PLUG

FOR BEARING HOUSINGS WHERE STRENGTH OF GREY CAST IRON MATERIAL IS STILL INADEQUATE, THESE HOUSINGS AN ALSO BE SUPPLIED IN CAST STEEL OR S.G. IRON . SUCH BEARING HOUSINGS CAN SUPPORT APPROXIMATELY TWICE THE LOAD PERMITTED FOR GREY CAST IRON HOUSINGS. THESE BEARING HOUSINGS ARE DIMENSIONALLY INTER CHANGEABLE AND SUITABLE TO BEARINGS OF INTERNATIONAL MAKE . JAYCO SN, SNA & SNH TYPE HOUSINGS ARE DESIGNED INTERCHANGEABLE FOR SAME BEARING SIZE AND MOUNTING DIMENSIONS. ALL HOUSINGS ARE SUPPLIED AS NON LOCATED TYPE. FOR LOCATING TYPE, SUITABLE LOCATING RING-FRB TO BE ORDERED SEPARATELY

SNH HOUSINGS FOR BEARINGS WITH CYLINDRICAL BORE



200 & 300 SERIES

SHAFT DIA :- 25 TO 140 MM	
MATERIAL	CAST IRON
MFG. STANDARD	IS 14347 - 1996 ISO 113 - 1994
SEAL	TC (FELT IN ALUMINUM HALF RINGS)
LUBRICATION	GREASE OR OIL
TYPE	HORIZONTAL SPLIT TYPE WITH TWO MOUNTING HOLES OF OVAL SHAPE.
APPLICATION	RELATIVELY HIGHER LOAD APPLICATION LIKE IN PAPER M/C, MINING, CONSTRUCTION AND CONVEYOR. BETTER SEALING ARRANGEMENT PERMITS DUSTY AND TEMPERATURE SURROUNDINGS.
OPTIONAL FEATURES AVAILABLE ON REQUEST	<ul style="list-style-type: none"> •FOUR FOUNDATION BOLT HOLES AT BASE •V SEAL (TA), DOUBLE LIP SEAL (TG), LABYRINTH SEAL(TS) •END COVER FOR CLOSED END TYPE •MATERIAL-C.S. GR.280/520, IS 1030 & S.G. IRON •SOLID BASE FOR HEAVY LOAD APPLICATION •DRAIN PLUG

For BEARING HOUSINGS WHERE STRENGTH OF GREY CAST IRON MATERIAL IS STILL INADEQUATE, THESE HOUSINGS AN ALSO BE SUPPLIED IN CAST STEEL OR S.G. IRON .SUCH BEARING HOUSINGS CAN SUPPORT APPROXIMATELY TWICE THE LOAD PERMITTED FOR GREY CAST IRON HOUSINGS. THESE BEARING HOUSINGS ARE DIMENSIONALLY INTER CHANGEABLE AND SUITABLE TO BEARINGS OF INTERNATIONAL MAKE . JAYCO SN, SNA & SNH TYPE HOUSINGS ARE DESIGNED INTERCHANGEABLE FOR SAME BEARING SIZE AND MOUNTING DIMENSIONS. ALL HOUSINGS ARE SUPPLIED AS NON LOCATED TYPE. FOR LOCATING TYPE, SUITABLE LOCATING RING-FRB TO BE ORDERED SEPARATELY

SNL BEARING HOUSING FOR BEARINGS WITH ADAPTER SLEEVE

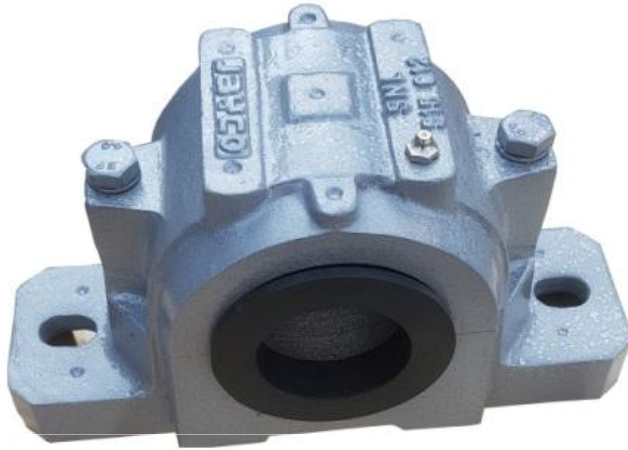

500 & 600 SERIES

SHAFT DIA :- 25 TO 140 MM	
MATERIAL	CAST IRON
MFG. STANDARD	IS 14347 - 1996 ISO 113 - 1994
SEAL	TC (FELT IN ALUMINUM HALF RINGS)
LUBRICATION	GREASE OR OIL
TYPE	HORIZONTAL SPLIT TYPE WITH TWO MOUNTING HOLES OF OVAL SHAPE.
APPLICATION	RELATIVELY HIGHER LOAD APPLICATION LIKE IN PAPER M/C, MINING, CONSTRUCTION AND CONVEYOR. BETTER SEALING ARRANGEMENT PERMITS DUSTY AND TEMPERATURE SURROUNDINGS.
OPTIONAL FEATURES AVAILABLE ON REQUEST	<ul style="list-style-type: none"> •FOUR FOUNDATION BOLT HOLES AT BASE •V SEAL (TA),DOUBLE LIP SEAL (TG), LABYRINTH SEAL(TS) •END COVER FOR CLOSED END TYPE •MATERIAL-C.S. GR.280/520, IS 1030 & S.G. IRON •SOLID BASE FOR HEAVY LOAD APPLICATION •DRAIN PLUG

FOR BEARING HOUSINGS WHERE STRENGTH OF GREY CAST IRON MATERIAL IS STILL INADEQUATE, THESE HOUSINGS AN ALSO BE SUPPLIED IN CAST STEEL OR S.G. IRON. SUCH BEARING HOUSINGS CAN SUPPORT APPROXIMATELY TWICE THE LOAD PERMITTED FOR GREY CAST IRON HOUSINGS. THESE BEARING HOUSINGS ARE DIMENSIONALLY INTER CHANGEABLE AND SUITABLE TO BEARINGS OF INTERNATIONAL MAKE . JAYCO SN, SNA & SNH TYPE HOUSINGS ARE DESIGNED INTERCHANGEABLE FOR SAME BEARING SIZE AND MOUNTING DIMENSIONS. ALL HOUSINGS ARE SUPPLIED AS NON LOCATED TYPE. FOR LOCATING TYPE, SUITABLE LOCATING RING-FRB TO BE ORDERED SEPARATELY

SNL HOUSINGS FOR BEARINGS WITH CYLINDRICAL BORE



200 & 300 SERIES

SHAFT DIA :- 25 TO 140 MM	
MATERIAL	CAST IRON
MFG. STANDARD	IS 14347 - 1996 ISO 113 - 1994
SEAL	TC (FELT IN ALUMINUM HALF RINGS)
LUBRICATION	GREASE OR OIL
TYPE	HORIZONTAL SPLIT TYPE WITH TWO MOUNTING HOLES OF OVAL SHAPE.
APPLICATION	RELATIVELY HIGHER LOAD APPLICATION LIKE IN PAPER M/C, MINING, CONSTRUCTION AND CONVEYOR. BETTER SEALING ARRANGEMENT PERMITS DUSTY AND TEMPERATURE SURROUNDINGS.
OPTIONAL FEATURES AVAILABLE ON REQUEST	<ul style="list-style-type: none"> •FOUR FOUNDATION BOLT HOLES AT BASE •V SEAL (TA),DOUBLE LIP SEAL (TG), LABYRINTH SEAL(TS) •END COVER FOR CLOSED END TYPE •MATERIAL-C.S. GR.280/520, IS 1030 & S.G. IRON •SOLID BASE FOR HEAVY LOAD APPLICATION •DRAIN PLUG

FOR BEARING HOUSINGS WHERE STRENGTH OF GREY CAST IRON MATERIAL IS STILL INADEQUATE, THESE HOUSINGS AN ALSO BE SUPPLIED IN CAST STEEL OR S.G. IRON(DUCTILE). SUCH BEARING HOUSINGS CAN SUPPORT APPROXIMATELY TWICE THE LOAD PERMITTED FOR GREY CAST IRON HOUSINGS. THESE BEARING HOUSINGS ARE DIMENSIONALLY INTER CHANGEABLE AND SUITABLE TO BEARINGS OF INTERNATIONAL MAKE LIKE SKF, FAG, NTN,ZKL,TIMKEN, ETC. JAYCO SN, SNA & SNH TYPE HOUSINGS ARE DESIGNED INTERCHANGEABLE FOR SAME BEARING SIZE AND MOUNTING DIMENSIONS. ALL HOUSINGS ARE SUPPLIED AS NON LOCATED TYPE. FOR LOCATING TYPE, SUITABLE LOCATING RING-FRB TO BE ORDERED SEPARATELY

SAF HOUSING FOR BEARING WITH ADAPTER

SLEEVES

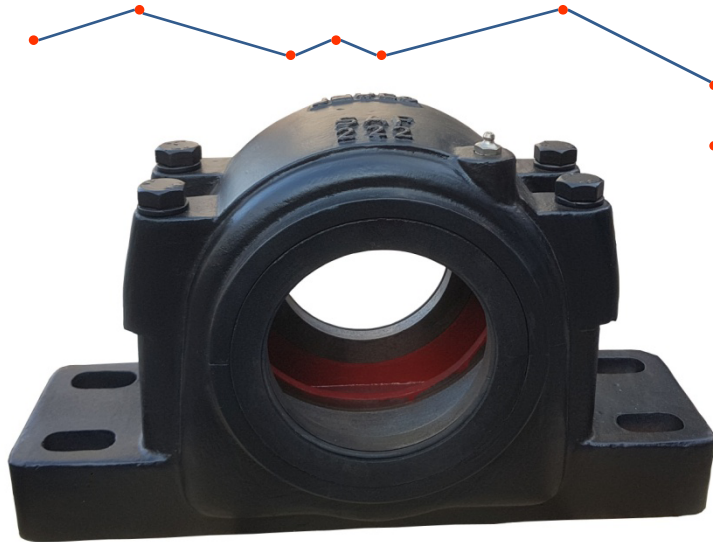

500 & 600 SERIES

SHAFT DIA :- 36.51 TO 207.61 MM(1,7/16" TO 8,3/16")	
MATERIAL	CAST IRON
SEAL	TRIPLE SEAL LER
LUBRICATION	GREASE OR OIL
TYPE	HORIZONTAL SPLIT TYPE WITH FOUR MOUNTING HOLES OF ELLIPTICAL SHAPE. THE HOUSING IS DESIGNED IN INCH SIZE (HOWEVER FOR CONVENIENCE EQUIVALENT METRIC SIZE IS GIVEN IN CATALOGUE)
APPLICATION	SUITABLE FOR HEAVIER LOAD AND SHOCK WITH UNUSUALLY DUSTY SURROUNDINGS. ITS EXTRA HEAVY FOOT PAD MAKES THE HOUSING RUGGED IN CONSTRUCTION. USED IN CONVEYOR, MINING, CEMENT, CHEMICAL PROCESSING, ETC. INDUSTRIES.

- TACONITE SEAL FOR HEAVILY CONTAMINATED SURROUNDINGS(EG. COAL, MINING INDUSTRY.)-TER
- MATERIAL : CAST STEEL - SAFS.
S.G IRON - SAFD
- FOR LOCATED BEARING TYPE, SUITABLE STABILIZING RING -SR IS SUPPLIED.
- LER CAN BE SUPPLIED IN ALUMINUM MATERIAL.(NORMALLY IT IS IN STEEL MATERIAL)

SAF HOUSING FOR BEARING WITH CYLINDRICAL BORE.

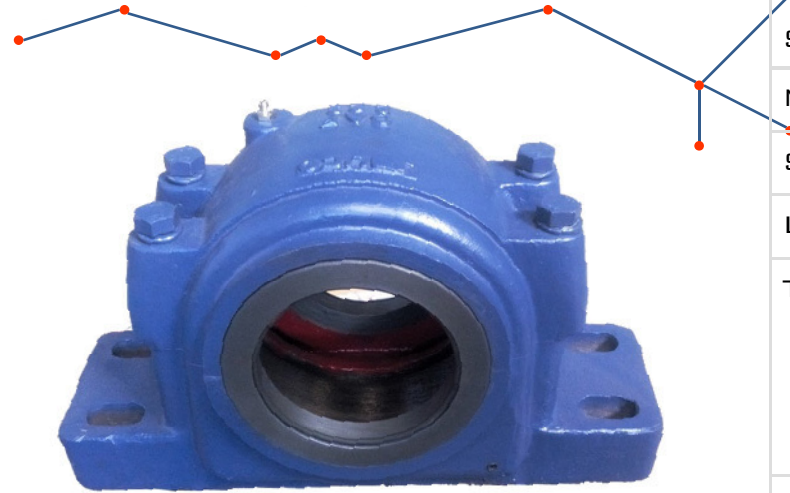

200 & 300 SERIES

SHAFT DIA :- 36.51 TO 207.61 MM(1,7/16" TO 8,3/16")	
MATERIAL	CAST IRON
SEAL	TRIPLE SEAL LER
LUBRICATION	GREASE OR OIL
TYPE	HORIZONTAL SPLIT TYPE WITH FOUR MOUNTING HOLES OF ELLIPTICAL SHAPE. THE HOUSING IS DESIGNED IN INCH SIZE (HOWEVER FOR CONVENIENCE EQUIVALENT METRIC SIZE IS GIVEN IN CATALOGUE)
APPLICATION	SUITABLE FOR HEAVIER LOAD AND SHOCK WITH UNUSUALLY DUSTY SURROUNDINGS. ITS EXTRA HEAVY FOOT PAD MAKES THE HOUSING RUGGED IN CONSTRUCTION. USED IN CONVEYOR, MINING, CEMENT, CHEMICAL PROCESSING, ETC. INDUSTRIES.

- TACONITE SEAL FOR HEAVILY CONTAMINATED SURROUNDINGS(EG. COAL, MINING INDUSTRY.)-TER
- MATERIAL : CAST STEEL - SAFS.
S.G IRON - SAFD
- FOR LOCATED BEARING TYPE, SUITABLE STABILIZING RING -SR IS SUPPLIED.
- LER CAN BE SUPPLIED IN ALUMINUM MATERIAL.(NORMALLY IT IS IN STEEL MATERIAL)



SD HOUSING FOR SPHERICAL ROLLER BEARINGS WITH ADAPTER SLEEVE



500 & SD 600 SERIES

SHAFT DIA :- 150 TO 300 MM	
MATERIAL	CAST IRON
SEAL	LABYRINTH - TS
LUBRICATION	GREASE OR OIL
TYPE	HORIZONTAL SPLIT TYPE WITH FOUR MOUNTING HOLES OF OVAL SHAPE
APPLICATION	RECOMMENDED FOR HEAVY LOAD APPLICATION WITH TEMPERATURE. EXTENSIVELY USED FOR CONTINUOUS SERVICE LIKE MATERIAL HANDLING, STEEL, MINING & PAPER INDUSTRY AND ROLLING MILL.
OPTIONAL FEATURES AVAILABLE ON REQUEST	<ul style="list-style-type: none"> •TACONITE SEAL •DRAIN PLUG, OIL LEVEL INDICATOR & OIL INLET •END COVER FOR CLOSED END TYPE •MATERIAL : CAST STEEL : SSD S. G. IRON : SDD

- WATER JACKETED SD500 & SD 600 WJ HOUSING ARE AVAILABLE FOR HIGH TEMPERATURE APPLICATION.
- SD 500 & SD 600 HOUSING ARE ALSO AVAILABLE FOR BEARING WITH CYLINDRICAL BORE.
- FOR BEARING HOUSINGS WHERE STRENGTH OF GREY CAST IRON MATERIAL IS STILL INADEQUATE, THESE HOUSINGS CAN ALSO BE SUPPLIED IN CAST STEEL OR S.G. IRON. SUCH BEARING HOUSINGS CAN SUPPORT APPROXIMATELY TWICE THE LOAD PERMITTED FOR GREY CAST IRON HOUSINGS.
- ALL HOUSINGS ARE SUPPLIED AS NON LOCATED TYPE. FOR LOCATING TYPE, SUITABLE LOCATING RING-FRB TO BE ORDERED SEPARATELY.

SD HOUSING FOR SPHERICAL ROLLER BEARING WITH ADAPTER

SLEEVE

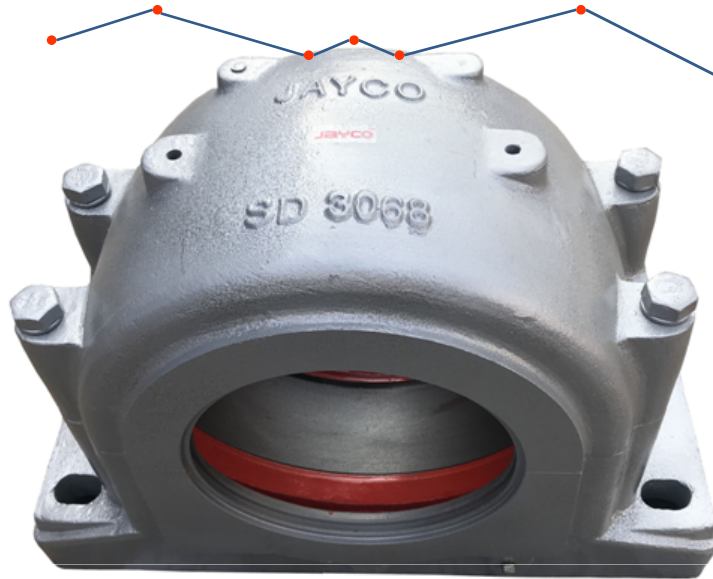

3000,3100 & 3200

SHAFT DIA :- 150 TO 300 MM	
MATERIAL	CAST IRON
SEAL	LABYRINTH - TS
LUBRICATION	GREASE OR OIL
TYPE	HORIZONTAL SPLIT TYPE WITH FOUR MOUNTING HOLES OF OVAL SHAPE
APPLICATION	RECOMMENDED FOR HEAVY LOAD APPLICATION WITH TEMPERATURE. EXTENSIVELY USED FOR CONTINUOUS SERVICE LIKE MATERIAL HANDLING, STEEL, MINING & PAPER INDUSTRY AND ROLLING MILL.
OPTIONAL FEATURES AVAILABLE ON REQUEST	<ul style="list-style-type: none"> •TAGONITE SEAL •DRAIN PLUG, OIL LEVEL INDICATOR & OIL INLET •END COVER FOR CLOSED END TYPE •MATERIAL : CAST STEEL : SSD S. G. IRON : SDD

- WATER JACKETED SD 3000,3100 AND 3200 WJ HOUSING ARE AVAILABLE FOR HIGH TEMPERATURE APPLICATION.
- SD 3000,3100 AND 3200 HOUSING ARE ALSO AVAILABLE FOR BEARING WITH CYLINDRICAL BORE.
- FOR BEARING HOUSINGS WHERE STRENGTH OF GREY CAST IRON MATERIAL IS STILL INADEQUATE, THESE HOUSINGS CAN ALSO BE SUPPLIED IN CAST STEEL OR S.G. IRON . SUCH BEARING HOUSINGS CAN SUPPORT APPROXIMATELY TWICE THE LOAD PERMITTED FOR GREY CAST IRON HOUSINGS.
- THESE BEARING HOUSINGS ARE DIMENSIONALLY INTER CHANGEABLE AND SUITABLE TO BEARINGS OF INTERNATIONAL MAKE .
- ALL HOUSINGS ARE SUPPLIED AS NON LOCATED TYPE. FOR LOCATING TYPE, SUITABLE LOCATING RING-FRB TO BE ORDERED SEPARATELY.

SOFN HOUSINGS FOR SPHERICAL ROLLER BEARINGS WITH CYLINDRICAL BORE.

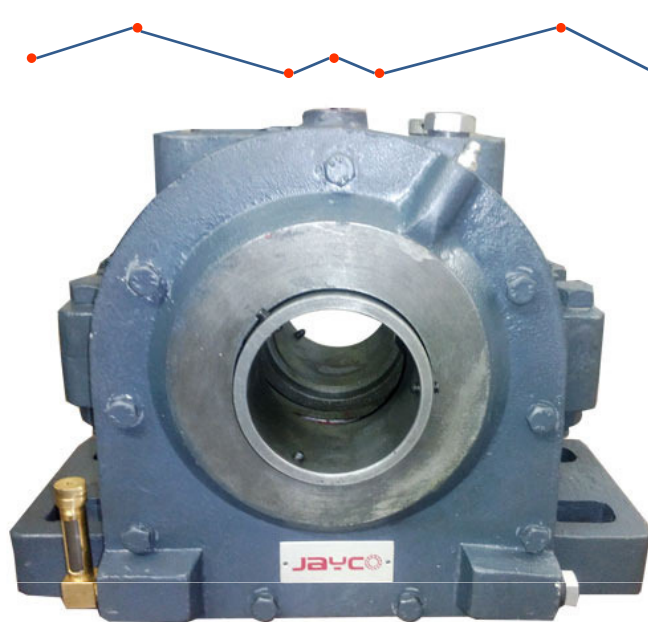

200 & 300 SERIES

SHAFT DIA :- 50 TO 240 MM	
MATERIAL	CAST IRON FG 260
SEAL	LABYRINTH SEAL WITH EXTERNAL OIL TRAPS
LUBRICATION	OIL BY SPLASH RING
TYPE	<ul style="list-style-type: none"> •HORIZONTAL SPLIT TYPE WITH END COVERS ON BOTH SIDES AND FOUR FOUNDATION HOLES OF RECTANGLE SHAPE. •ACCESSORIES SUPPLIED WITH ONE SET OF HOUSING ARE : •OIL LEVEL INDICATOR-1, SEALING COLLAR-2, OIL RING-1, DRAIN PLUG-7, AIR BREATHER-1, ONE M24 TAPPED HOLE FOR CONNECTION OF MERCURY IN OIL THERMOMETER, ONE M18 TAPPED HOLE FOR CONNECTION OF RESISTANCE THERMOMETER, EYE BOLT-1, AND GASKET-2.
APPLICATION	MOST VERSATILE AND SUITABLE FOR CONTINUOUS AND HEAVY LOAD APPLICATIONS. FOR HIGH SPEED AND HIGH TEMPERATURE SERVICE EXTERNAL OIL CIRCULATING ARRANGEMENT IS POSSIBLE. POPULAR FOR FAN APPLICATION THERE IS FACILITY TO MEASURE BEARING TEMPERATURE AND VIBRATION.
OPTIONAL FEATURES AVAILABLE ON REQUEST	<ul style="list-style-type: none"> •BL, BF, AL OR AF AS PER LOCATED OR FREE BEARING AND CLOSED / OPEN END. •OIL INLET ASSEMBLY (FOR FORCED FEED LUBRICATION) •MATERIAL : CAST STEEL : SOFNS S. G. IRON : SOFND

WATER JACKETED SOFNS---WJ HOUSINGS ARE AVAILABLE FOR HIGH TEMPERATURE APPLICATION.

WATER COOLING COILS ARE ALSO PROVIDED FOR MEDIUM RANGE OF TEMPERATURE, DESIGNATED SOFN---WC

SOFN HOUSING ARE ALSO AVAILABLE FOR BEARING WITH CYLINDRICAL BORE.

FOR BEARING HOUSINGS WHERE STRENGTH OF GREY CAST IRON MATERIAL IS STILL INADEQUATE, THESE HOUSINGS CAN ALSO BE SUPPLIED IN CAST STEEL OR SPHERICAL GRAPHITE IRON. SUCH BEARING HOUSINGS CAN SUPPORT APPROXIMATELY TWICE THE LOAD PERMITTED FOR GREY CAST IRON HOUSINGS.

SOFN HOUSINGS FOR SPHERICAL ROLLER BEARINGS WITH ADAPTER SLEEVE



500 & 600 SERIES

SHAFT DIA :- 50 TO 240 MM	
MATERIAL	CAST IRON FG 260 - IS 210,1993 (ISO/R 185-1965, GRADE25)
SEAL	LABYRINTH SEAL WITH EXTERNAL OIL TRAPS
LUBRICATION	OIL BY SPLASH RING
TYPE	<ul style="list-style-type: none"> •HORIZONTAL SPLIT TYPE WITH END COVERS ON BOTH SIDES AND FOUR FOUNDATION HOLES OF RECTANGLE SHAPE. •ACCESSORIES SUPPLIED WITH ONE SET OF HOUSING ARE : <ul style="list-style-type: none"> •OIL LEVEL INDICATOR-1, SEALING COLLAR-2, OIL RING-1, DRAIN PLUG-7, AIR BREATHER-1, ONE M24 TAPPED HOLE FOR CONNECTION OF MERCURY IN OIL THERMOMETER, ONE M18 TAPPED HOLE FOR CONNECTION OF RESISTANCE THERMOMETER, EYE BOLT-1, AND GASKET-2.
APPLICATION	MOST VERSATILE AND SUITABLE FOR CONTINUOUS AND HEAVY LOAD APPLICATIONS. FOR HIGH SPEED AND HIGH TEMPERATURE SERVICE EXTERNAL OIL CIRCULATING ARRANGEMENT IS POSSIBLE. POPULAR FOR FAN APPLICATION THERE IS FACILITY TO MEASURE BEARING TEMPERATURE AND VIBRATION.
OPTIONAL FEATURES AVAILABLE ON REQUEST	<ul style="list-style-type: none"> •BL, BF, AL OR AF AS PER LOCATED OR FREE BEARING AND CLOSED / OPEN END. •OIL INLET ASSEMBLY (FOR FORCED FEED LUBRICATION) •MATERIAL : CAST STEEL : SOFNS S. G. IRON : SOFND

WATER JACKETED SOFNS---WJ HOUSINGS ARE AVAILABLE FOR HIGH TEMPERATURE APPLICATION.

WATER COOLING COILS ARE ALSO PROVIDED FOR MEDIUM RANGE OF TEMPERATURE, DESIGNATED SOFN---WC
SOFN HOUSING ARE ALSO AVAILABLE FOR BEARING WITH CYLINDRICAL BORE.

FOR BEARING HOUSINGS WHERE STRENGTH OF GREY CAST IRON MATERIAL IS STILL INADEQUATE, THESE HOUSINGS CAN ALSO BE SUPPLIED IN CAST STEEL OR SPHERICAL GRAPHITE IRON (DUCTILE). SUCH BEARING HOUSINGS CAN SUPPORT APPROXIMATELY TWICE THE LOAD PERMITTED FOR GREY CAST IRON HOUSINGS.

THESE BEARING HOUSINGS ARE DIMENSIONALLY INTER CHANGEABLE AND SUITABLE TO BEARINGS OF INTERNATIONAL MAKE LIKE SKF, FAG, NTN, ZKL, TIMKEN, ETC.

SBD HOUSINGS FOR SPHERICAL ROLLER BEARINGS WITH ADAPTER SLEEVE ON PLAIN CYLINDRICAL SHAFTS

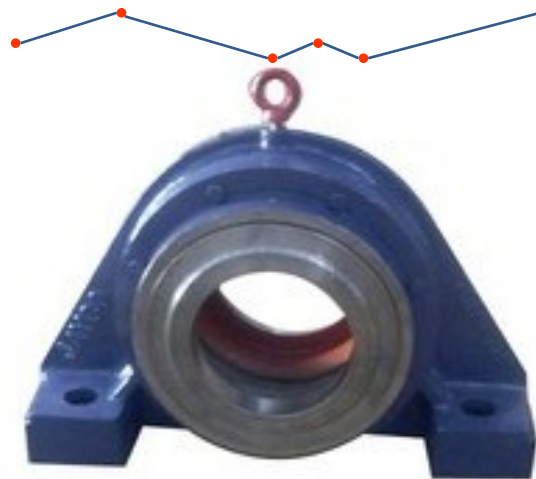

**2200,3000,3100 &
3200 SERIES**

	SHAFT DIA :- 90 TO 103 MM
MATERIAL	CAST STEEL GR. 280/520, IS 1030
LUBRICATION	GREASE
TYPE	NON-SPLIT TYPE WITH END COVERS AND FOUR MOUNTING HOLES OF OVAL SHAPE.
APPLICATION	THE RUGGED CONSTRUCTION OF THIS HOUSING ALLOWS HEAVY LOADS NOT ONLY ACTING TOWARDS THE BOTTOM SUPPORT SURFACE, BUT ALSO IN OTHER DIRECTION (E.G. RIGHT ANGLES) , E.G. MINING, CONVEYOR, ETC.
OPTIONAL FEATURES AVAILABLE ON REQUEST	<ul style="list-style-type: none"> •END COVER FOR CLOSED END. •LOCATED OR NON LOCATED BEARING •MATERIAL : CAST STEEL : SBDC S. G. IRON : SBDD •LOCATED AND NON-LOCATED TYPE <ul style="list-style-type: none"> • FOR BEARINGS WITH ADEPTER SLEEVE FOR STEPPED CYLINDRICAL SHAFT:SBDS ---- G • FOR BEARING WITH SINGLE STEPPED CYLINDRICAL SHAFT:SBDS ---- E • FOR BEARING WITH DOUBLE STEPPED CYLINDRICAL SHAFT:SBDS ---- G

WATER JACKETED SBD WJ HOUSINGS ARE AVAILABLE FOR HIGH TEMPERATURE APPLICATION.

SBD HOUSING ARE ALSO AVAILABLE FOR BEARING WITH CYLINDRICAL BORE.

THESE BEARING HOUSINGS ARE DIMENSIONALLY INTER CHANGEABLE AND SUITABLE TO BEARINGS OF INTERNATIONAL MAKE LIKE SKF, FAG, NTN, ZKL, TIMKEN, ETC.

FOR SBD TYPE IT IS NECESSARY TO SPECIFY REQUIREMENT FOR LOCATED BEARING TYPE OR NON-LOCATED BEARING TYPE BECAUSE LOOSE LOCATING RINGS (FRB) ARE NOT USED. INSTEAD, THE BEARING WIDTH INSIDE THE HOUSING IS MACHINED TO SUIT LOCATED OR NON-LOCATED TYPE. PUT SUFFIX AS UNDER TO INDICATE THIS REQUIREMENT :

BL : HOUSING FOR THRU' SHAFT & NON LOCATING BEARING BF : HOUSING FOR THRU' SHAFT & LOCATING BEARING
AL : HOUSING FOR SHAFT END (WITH END COVER) & NON-LOCATING BEARING AF : HOUSING FOR SHAFT END (WITH END COVER) & LOCATING BEARING

THDS-TAKE UP UNIT



SHAFT DIA :- 50 TO 530 MM	
MATERIAL	CAST STEEL GRADE 280/520, IS 1030-1989(ISO/R 185, GRADE 230-450 SG 460)
LUBRICATION	GREASE
TYPE	NON-SPLIT TYPE WITH END COVERS
APPLICATION	CONVEYOR, BELT TIGHTENING PULLEY
OPTIONAL FEATURES AVAILABLE ON REQUEST	<ul style="list-style-type: none"> •BL, BF, AL OR AF •CLOSED END OR OPEN END. •MATERIAL : CAST STEEL : THDC S. G. IRON : THDD

THD TAKE-UP HOUSINGS FOR SPHERICAL ROLLER BEARINGS WITH ADAPTER SLEEVE ON PLAIN CYLINDRICAL SHAFTS.

- THD HOUSING ARE ALSO AVAILABLE FOR BEARING WITH CYLINDRICAL BORE.
- FOR BEARING HOUSINGS WHERE STRENGTH OF GREY CAST IRON MATERIAL IS STILL INADEQUATE, THESE HOUSINGS CAN ALSO BE SUPPLIED IN CAST STEEL OR SPHERICAL GRAPHITE IRON . SUCH BEARING HOUSINGS CAN SUPPORT APPROXIMATELY TWICE THE LOAD PERMITTED FOR GREY CAST IRON HOUSINGS.
- THESE BEARING HOUSINGS ARE DIMENSIONALLY INTER CHANGEABLE AND SUITABLE TO BEARINGS OF INTERNATIONAL MAKE .
- FOR THD TYPE IT IS NECESSARY TO SPECIFY REQUIREMENT FOR LOCATED BEARING TYPE OR NON-LOCATED BEARING TYPE BECAUSE LOOSE LOCATING RINGS (FRB) ARE NOT USED. INSTEAD, THE BEARING WIDTH INSIDE THE HOUSING IS MACHINED TO SUIT LOCATED OR NON-LOCATED TYPE. PUT SUFFIX AS UNDER TO INDICATE THIS REQUIREMENT :

- BL : HOUSING FOR THRU¹ SHAFT & NON LOCATING BEARING
- BF : HOUSING FOR THRU¹ SHAFT & LOCATING BEARING
- AL : HOUSING FOR SHAFT END (WITH END COVER) & NON-LOCATING BEARING
- AF : HOUSING FOR SHAFT END (WITH END COVER) & LOCATING BEARING



BND TYPE BEARING HOUSINGS UNIT

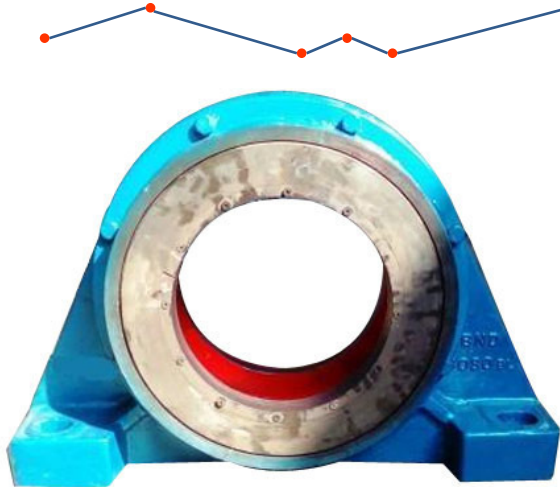

EXTRA HEAVY DUTY SERIES	
SIZES	SHAFT DIA RANGE :- 65 TO 420 MM
MATERIAL	CAST STEEL GR 280/520 IS 1030
SEAL	LABYRINTH
LUBRICATION	GREASE
TYPE	UN SPLIT HOUSING (SINGLE PIECE) (BASICALLY SIMILAR TO SBD TYPE WITH VARIATION IN CONSTRUCTION DESIGN)
APPLICATION	BND BEARING HOUSING ARE USED FOR VERY DEMANDING OPERATING CONDITIONS. PREFERRED BY BELT CONVEYOR APPLICATION, IT IS USED IN PROCESSING INDUSTRY LIKE HARD CRUSHERS, SUGAR CANE MILL DRIVES, ROTOR SHAFT IN WIND TURBINE, ETC
OPTIONAL FEATURES AVAILABLE ON REQUEST	<ul style="list-style-type: none"> •BL, BF, AL, OR AF •END COVER FOR CLOSED AND. •TACONITE SEAL WITH V RING. •MATERIAL : S.G. IRON •FOR BEARING WITH TAPERED BORE AND BEARING WITH CYLINDRICAL BORE.

BND HOUSING SHOULD NOT BE SUBJECTED TO AN AXIAL LOAD GREATER THAN 20% OF THE BREAKING LOAD IN VERTICAL DIRECTION. IT IS RECOMMENDED THAT THE HOUSINGS SHOULD BE SECURED IN THE LOAD DIRECTION BY MEANS OF DOWELS.

- WATER JACKETED BND--WJ HOUSINGS ARE AVAILABLE FOR HIGH TEMPERATURE APPLICATION.
- BND HOUSING ARE ALSO AVAILABLE FOR BEARING WITH CYLINDRICAL BORE.
- FOR BEARING HOUSINGS WHERE STRENGTH OF GREY CAST IRON MATERIAL IS STILL INADEQUATE, THESE HOUSINGS CAN BE SELECTED IN CAST STEEL OR SPHERICAL GRAPHITE IRON (DUCTILE). SUCH BEARING HOUSINGS CAN SUPPORT APPROXIMATELY TWICE THE LOAD PERMITTED FOR GREY CAST IRON HOUSINGS.

SDJ HOUSINGS FOR SPHERICAL ROLLER BEARINGS WITH ADAPTER SLEEVE

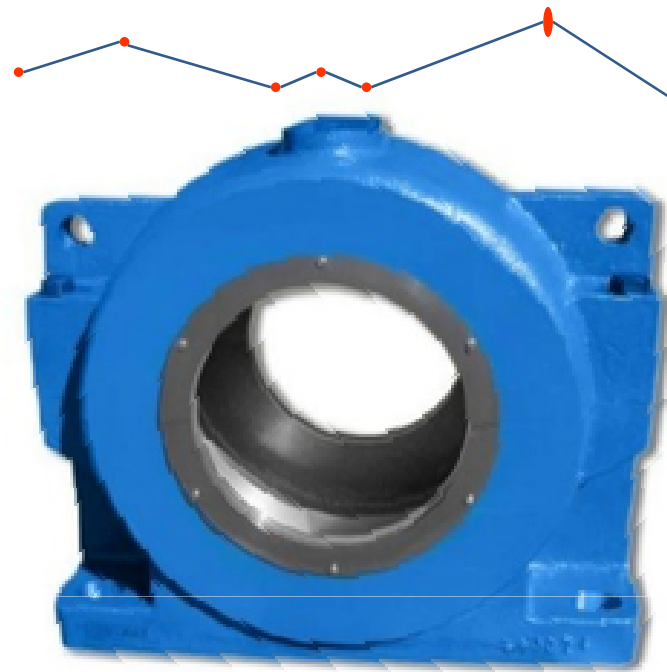

SHAFT DIA :- 320 TO 450 MM	
MATERIAL	CAST IRON FG 260 - IS 210, 1993(ISO/R 185-1961, GRADE 25)
SEAL	LABYRINTH
LUBRICATION	GREASE OR OIL
TYPE	HORIZONTAL SPLIT TYPE WITH FOUR MOUNTING HOLES OF OVAL SHAPE.
APPLICATION	THIS HEAVY DUTY PLUMMER BLOCK HOUSING IS EXTENSION OF THE SD TYPE HOUSING. SUITABLE FOR SEVERE LOAD CONDITION AND VARIETY OF HEAVY DUTY SERVICE LIKE IN STEEL INDUSTRY & CEMENT INDUSTRY, ETC
OPTIONAL FEATURES AVAILABLE ON REQUEST	<ul style="list-style-type: none"> •LOCATED AND NON-LOCATED TYPE. •END COVER •MATERIAL : CAST STEEL : SDJS S. G. IRON : SDJD CAST IRON : SDJC

- SDJ HOUSING ARE AVAILABLE FOR BEARINGS WITH CYLINDRICAL BORE. FOR BEARING SERIES OTHER THAN 23100CCK, SDJ HOUSING IS AVAILABLE ON SPECIFIC REQUEST.
- SDJ 3100 HOUSING ARE ALSO AVAILABLE FOR BEARING WITH CYLINDRICAL BORE.
- FOR BEARING HOUSINGS WHERE STRENGTH OF GREY CAST IRON MATERIAL IS STILL INADEQUATE, THESE HOUSINGS CAN ALSO BE SUPPLIED IN CAST STEEL OR SPHERICAL GRAPHITE IRON . SUCH BEARING HOUSINGS CAN SUPPORT APPROXIMATELY TWICE THE LOAD PERMITTED FOR GREY CAST IRON HOUSINGS.
- FOR SDJ TYPE IT IS NECESSARY TO SPECIFY REQUIREMENT FOR LOCATED BEARING TYPE OR NON-LOCATED BEARING TYPE BECAUSE LOOSE LOCATING RINGS (FRB) ARE NOT USED. INSTEAD, THE BEARING WIDTH INSIDE THE HOUSING IS MACHINED TO SUIT LOCATED OR NON-LOCATED TYPE. PUT SUFFIX AS UNDER TO INDICATE THIS REQUIREMENT.

PDN TYPE BEARING HOUSINGS

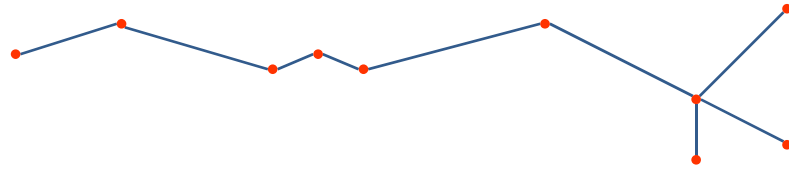

EXTRA HEAVY DUTY SERIES

SIZES	SHAFT DIA RANGE 25-125 MM
MATERIAL	CAST IRON FG260 , IS 210 (ISO /R - 185-1961 - GR 25)
SEAL	FELT & V RING
LUBRICATION	GREASE, OIL CIRCULATING BATH
TYPE	THESE ARE TWO-BEARING HOUSINGS WHERE EITHER DGBB, ACB OR CRB ARE FITTED AT EACH END OF HOUSING TO SUPPORT AN OVER HANGING SHAFT, WHERE, ON EXTENDED SHAFT END A FAN CAN BE FITTED THRU COUPLING. IT IS IMPORTANT THAT THE SEATING OF TWO BEARINGS AT TWO ENDS ARE CONCENTRIC AND MACHINED ACCURATELY IN ONE SETTING. THIS FEATURE IS VERY IMPORTANT FOR VIBRATION-FREE VIBRATION OF THE ASSEMBLY. THE BEARING CAN ACCOMMODATE AXIAL LOAD IN BOTH DIRECTIONS IN ADDITION TO RADIAL LOADS AND ARE SUITABLE FOR RELATIVELY HIGH SPEED OPERATION. THE PDN & PDD HOUSINGS ARE SUPPLIED AS ASSEMBLED SET CONSISTING OF HOUSING BODY, GREASE NIPPLE, COVERS WITH HEXAGONAL SCREWS & SPRING RING / WASHER, SNAP RING, SPACER SLEEVE (AS THE CASE MAY BE), FLINGER RINGS, SEAL AND O RING.
APPLICATION	PDN & PDD HOUSINGS SUPPORT OVER HANGING SHAFTS WHICH CARRY THE IMPELLER OF FAN. THEY CAN ALSO BE USED ELSE WHERE LIKE CENTRIFUGAL PUMP, CIRCULAR SAW AND IN TRANSMISSION. DUE TO ITS UNIQUE CONSTRUCTION THEY AS SUITABLE FOR RELATIVELY HIGH SPEED OPERATION. ACCURATELY MACHINED HOUSING RESULTS IN VIBRATION FREE OPERATION.
OPTIONAL FEATURES AVAILABLE ON REQUEST	<ul style="list-style-type: none"> •PDN – ONE DEEP GROOVE BALL BEARING (6300 & 6200) EACH AT TWO ENDS OF HOUSING •PDP – ONE CYLINDRICAL ROLLER BEARING AT ONE END AND TWO ANGULAR CONTACT BALL BEARINGS AT OTHER END OF HOUSING.(7200 BCB & NU 2200 ECP) •PDR – TWO CYLINDRICAL ROLLER BEARINGS AT ONE END AND ONE DEEP GROOVE BALL BEARING AT OTHER END. (NU 300ECP & 6300)

SDG HOUSING SPHERICAL ROLLER BEARINGS WITH ADAPTER SLEEVE.

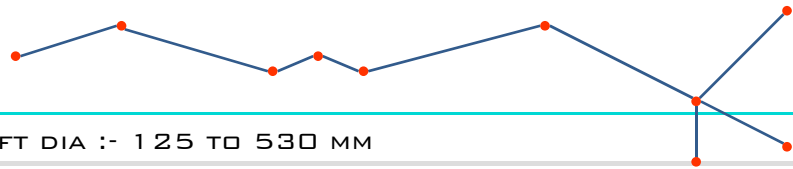

SHAFT DIA :- 125 TO 530 MM	
MATERIAL	CAST IRON
SEAL	LABYRINTH OR FELT
LUBRICATION	GREASE
TYPE	HORIZONTAL SPLIT TYPE WITH END COVERS AND FOUR MOUNTING HOLES OF OVAL SHAPE.
APPLICATION	SUITABLE FOR VERY HEAVY DUTY SERVICES AND CONTINUOUS OPERATION. WIDELY USED STEEL & CEMENT INDUSTRY, BALL MILL & CRASHER APPLICATION, MINING, ETC.
OPTIONAL FEATURES AVAILABLE ON REQUEST	<ul style="list-style-type: none"> •END COVER FOR CLOSED END. •LOCATED OR NON LOCATED BEARING •MATERIAL : CAST STEEL : SDJS S. G. IRON : SDJD •V-SEAL AS SUPPLEMENTARY SEAL. <ul style="list-style-type: none"> FOR BEARINGS WITH WITHDRAWAL SLEEVE:SDGC3100 D FOR BEARING WITH CYLINDRICAL BORE ON STEPPED CYL STAFF: SDGC3100 G FOR BEARING WITH ADAPTER SLEEVE FOR STEPPED SHAFT:SDGC 3100 C
<ul style="list-style-type: none"> •WATER JACKETED SDG 3100 WJ HOUSINGS ARE AVAILABLE FOR HIGH TEMPERATURE APPLICATION. •SDG HOUSING ARE AVAILABLE FOR FOLLOWING SERIES OF BEARINGS ALSO: 3900,4000,4100 39/500,530, 560, 600, 630, 670, 710 40/500, 530, 560, 600, 630 41/500, 530,560. •SDG HOUSING ARE AVAILABLE FOR BEARINGS WITH CYLINDRICAL BORE. •FOR BEARING HOUSINGS WHERE STRENGTH OF GREY CAST IRON MATERIAL IS STILL INADEQUATE, THESE HOUSINGS CAN ALSO BE SUPPLIED IN CAST STEEL OR SPHERICAL GRAPHITE IRON . SUCH BEARING HOUSINGS CAN SUPPORT APPROXIMATELY TWICE THE LOAD PERMITTED FOR GREY CAST IRON HOUSINGS. 	



SDAF TYPE BEARING HOUSINGS

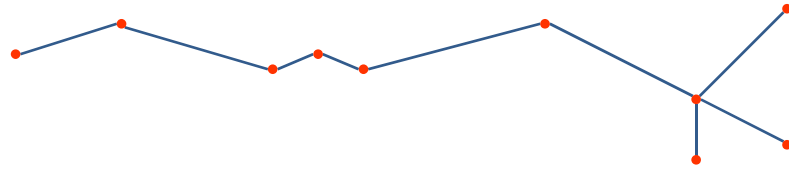

EXTRA HEAVY DUTY SERIES

SIZES	SUITABLE FOR BEARING SERIES : 22200CC, 22300CC, 22200CCK, 22300CCK.
MATERIAL	CAST IRON FG 260, IS 210/99 B(ISO/R. 185-1961 GR 25)
SEAL	TRIPLE SEAL RING : LER
LUBRICATION	OIL OR GREASE (IMPROVED DESIGN ALLOWS THE LUBRICANT TO PASS THROUGH THE HOUSING DIRECTLY TO THE CENTER OF BEARINGS; WHICH ARRANGEMENT ALLOWS IT POSSIBLE FOR LUBRICANT TO REACH THE ROLLING SURFACES OF BEARINGS QUICKLY. LARGE DRAIN HOLE UNDER TRIPLE SEAL ENSURES POSITIVE FLOW OF LUBRICANT TO RESERVOIR IN HOUSING AND PREVENT LEAKAGE OF OIL OUTSIDE HOUSING.
TYPE	HORIZONTAL SPLIT TYPE WITH FOUR MOUNTING HOLES OF ELLIPTICAL SHAPE. THIS DESIGN IS HEAVY DUTY VERSION OF SAF TYPE. THESE HOUSINGS HAVE RADIAL LABYRINTH SEAL WHICH ENSURE MAXIMUM SEALING EFFECTIVENESS WHERE SURROUNDING CONDITIONS ARE UNUSUALLY DUSTY. EXTRA HEAVY FOOT PADS ARE PROVIDED FOR BETTER BOLT SEATING AND RIGID ASSEMBLY.
APPLICATION	SDAF HOUSINGS ARE RUGGED IN CONSTRUCTION AND CAN WITHSTAND HEAVIEST LOADS AND SHOCKS. THEY ARE USED IN VERY HEAVY APPLICATION LIKE USED MINING, STEEL PLANT, CRUSHER ETC. THESE HOUSINGS ARE DESIGNED IN INCH SIZE, AND PREFERRED IN USA.
OPTIONAL FEATURES AVAILABLE ON REQUEST	<ul style="list-style-type: none"> •TACONITE SEAL (TER) FOR HEAVILY DUSTY AND CONTAMINATED SURROUNDINGS EG. COAL, MINING INDUSTRY. •MATERIAL : CAST STEEL : SDAFS S. G. IRON : SDAFD

LOE TYPE BEARING HOUSINGS

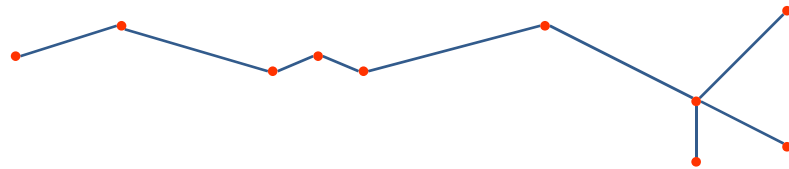

EXTRA HEAVY DUTY SERIES	
SIZES	SHAFT DIA 100 TO 240 MM. SUITABLE TO BEARINGS: 22300ES, 22200ES; 22300ESK, 22200ESK.
MATERIAL	CAST IRON FG- 260, IS 210, 1993(ISO /R -185 -1961 GR.25)
SEAL	LABYRINTH SEAL WITH EXTERNAL OIL TRAPS.
LUBRICATION	OIL BY SPLASH RING & OIL SUMP.
TYPE	HORIZONTAL SPLIT TYPE WITH END COVERS ON BOTH SIDES AND FOUR FOUNDATION HOLES OF RECTANGLE SHAPE. ACCESSORIES SUPPLIED WITH ONE SET OF HOUSING ARE : OIL LEVEL INDICATOR-1, SEALING COLLAR-2, OIL RING-1, DRAIN PLUG-7, AIR BREATHER-1, ONE M24 TAPPED HOLE FOR CONNECTION OF MERCURY IN OIL THERMOMETER, ONE M18 TAPPED HOLE FOR CONNECTION OF RESISTANCE THERMOMETER, EYE BOLT-1, AND GASKET-2.
APPLICATION	LOE IS MOST VERSATILE AND SUITABLE FOR CONTINUOUS AND HEAVY LOAD, HIGH SPEED BEARING APPLICATION WITH HIGH TEMPERATURE SERVICE. LOE TYPE IS PREFERRED FOR LARGE INDUSTRIAL FAN APPLICATION WHERE IT GIVES RELIABLE SERVICE WITHOUT ANY INTERRUPTION OR STOPPAGE. IT IS ALSO USED IN CEMENT, MINING AND SIMILAR INDUSTRIES. FOR TROUBLE FREE OPERATION OF THIS HOUSING, THERE IS PROVISION TO ATTACH THERMOMETER AND VIBRATION PROBE FOR MEASUREMENT OF TEMPERATURE AND VIBRATION.
OPTIONAL FEATURES AVAILABLE ON REQUEST	<ul style="list-style-type: none"> •BL, BF, AL, OR AF AS PER LOCATED OR FREE BEARING AND CLOSED OR OPEN END. •OIL INLET ASSEMBLY (FOR FORCED FEED LUBRICATION) •MATERIAL : CAST STEEL : LOE(ST)---- S. G. IRON : LOE(DT)----

PDN TYPE BEARING HOUSINGS



EXTRA HEAVY DUTY SERIES	
SIZES	SHAFT DIA RANGE 25-125 MM
MATERIAL	CAST IRON FG260 , IS 210 (ISO /R - 185-1961 - GR 25)
SEAL	FELT & V RING
LUBRICATION	GREASE, OIL , OIL CIRCULATING BATH
TYPE	THESE ARE TWO-BEARING HOUSINGS WHERE EITHER DGBB, ACB OR CRB ARE FITTED AT EACH END OF HOUSING TO SUPPORT AN OVER HANGING SHAFT, WHERE, ON EXTENDED SHAFT END A FAN CAN BE FITTED THRU COUPLING. IT IS IMPORTANT THAT THE SEATING OF TWO BEARINGS AT TWO ENDS ARE CONCENTRIC AND MACHINED ACCURATELY IN ONE SETTING. THIS FEATURE IS VERY IMPORTANT FOR VIBRATION-FREE VIBRATION OF THE ASSEMBLY. THE BEARING CAN ACCOMMODATE AXIAL LOAD IN BOTH DIRECTIONS IN ADDITION TO RADIAL LOADS AND ARE SUITABLE FOR RELATIVELY HIGH SPEED OPERATION. THE PDN & PDD HOUSINGS ARE SUPPLIED AS ASSEMBLED SET CONSISTING OF HOUSING BODY, GREASE NIPPLE, COVERS WITH HEXAGONAL SCREWS & SPRING RING / WASHER, SNAP RING, SPACER SLEEVE (AS THE CASE MAY BE), FLINGER RINGS, SEAL AND O RING.
APPLICATION	PDN & PDD HOUSINGS SUPPORT OVER HANGING SHAFTS WHICH CARRY THE IMPELLER OF FAN. THEY CAN ALSO BE USED ELSE WHERE LIKE CENTRIFUGAL PUMP, CIRCULAR SAW AND IN TRANSMISSION. DUE TO ITS UNIQUE CONSTRUCTION THEY AS SUITABLE FOR RELATIVELY HIGH SPEED OPERATION. ACCURATELY MACHINED HOUSING RESULTS IN VIBRATION FREE OPERATION.



SQUARE / REGULAR BEARING HOUSINGS

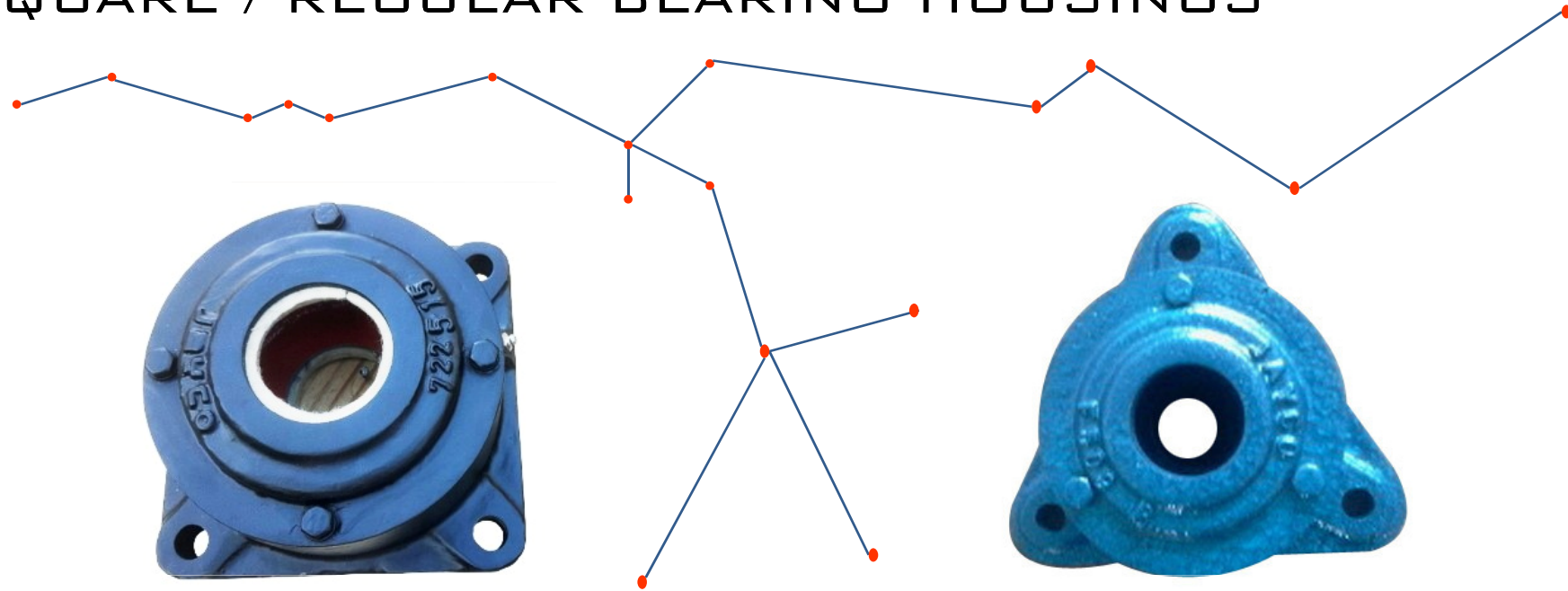

SQUARE FLANGED SERIES / TRIGULAR FLANGED SERIES ARE DESIGNED FOR SIDE WALL MOUNTING FOR MACHINE WALL TO CONVENIENTLY SUPPORT BEARINGS. THE 722500 SERIES SQUARE FLANGED HOUSINGS ARE SUITABLE FOR SELF-ALIGNING BALL BEARING OF SERIES 12 K AND 22 K AND SPHERICAL ROLLER BEARING OF SERIES 22 K ON ADAPTER SLEEVES. THEY ARE ONE PIECE DESIGN WITH COVER ON ONE SIDE AND FLANGE FOR MOUNTING ON OTHER SIDE OF HOUSING.

THEY ARE AVAILABLE FOR SHAFT DIAMETER FROM 65 TO 100 MM IN TRIANGULAR FLANGES HAVING THREE MOUNTING HOLES AND FOR SHAFT DIAMETER 65 TO 100 MM IN SQUARE FLANGES HAVING FOUR MOUNTING HOLES. THE FLANGED HOUSINGS ARE MANUFACTURED IN GRAY CAST IRON. THESE HOUSINGS ARE DESIGNED FOR GREASE LUBRICATION. SUITABLE GREASING NIPPLE IS PROVIDED.

BEARING SEALS / ACCESSORIES

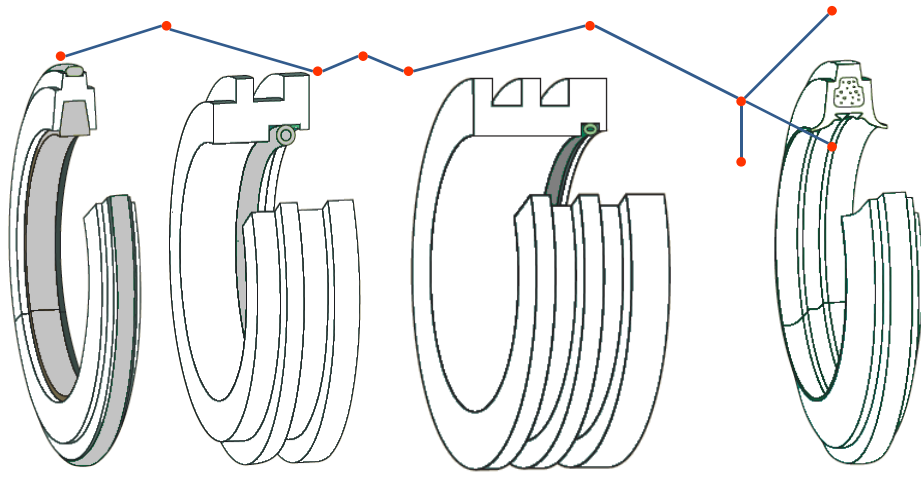

TC

TS

**LABRINTH
SEAL**

TG

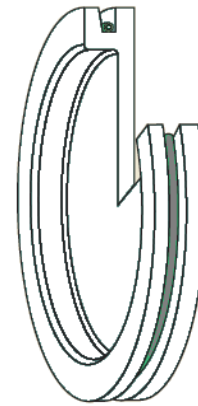

**END
COVER**



V RING

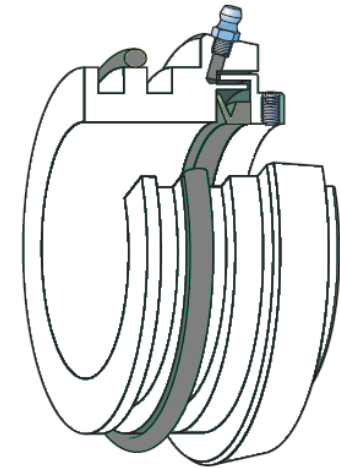

**TECONITE
SEALS**

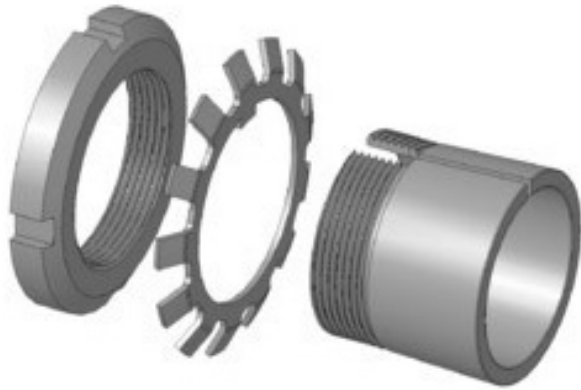

ADAPTER SLEEVE

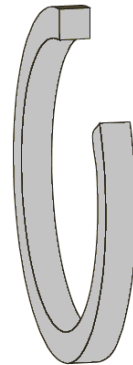

**LOCATING
RING**

SELECTION OF SEAL FOR BEARING HOUSINGS SHOULD BE DONE CAREFULLY SINCE SEAL HAS VERY IMPORTANT ROLE IN FUNCTIONING OF BEARING AND BEARING HOUSING. AN EFFICIENT SEAL ADDS TO THE LIFE OF A BEARING BY KEEPING DIRT, DUST, CONTAMINATION AND FOREIGN PARTICLE OUTSIDE THE BEARING HOUSING WHEREAS IT PREVENTS THE LUBRICANT FROM LEAKING OUT OF BEARING HOUSING. TO SATISFY THIS BASIC REQUIREMENT OF A TROUBLE-FREE BEARING, A SUITABLE SEAL PLAYS VERY IMPORTANT ROLE.



CUSTOMIZED HOUSINGS

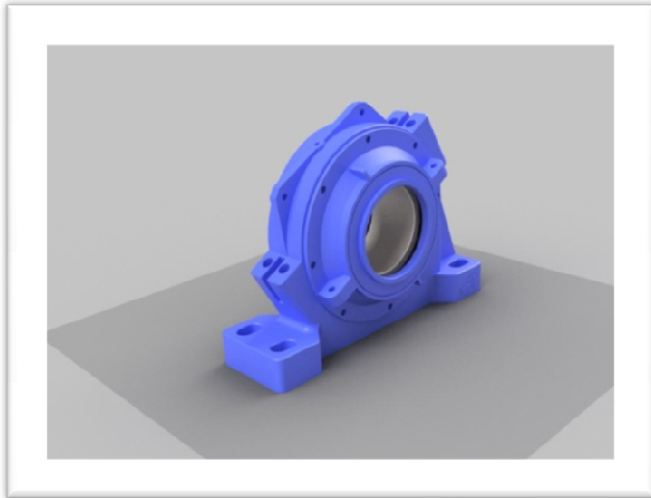
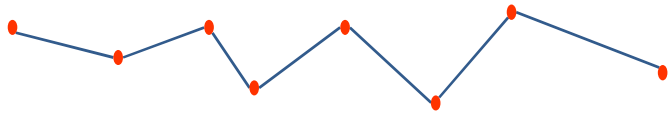

JAYCO ARE PROVIDING NUMBER OF VARIANTS AND CUSTOMIZED CHANGES IN ALL TYPES OF PLUMMER BLOCK HOUSINGS DESCRIBES IN JAYCO TECHNICAL CATALOGUE. BUT STILL THERE IS NECESSITY FOR TAILOR MADE PLUMMER BLOCK HOUSING FOR VERY SPECIFIC REQUIREMENT OF INDUSTRIAL APPLICATION. SUCH REQUIREMENT ARISES DUE TO SPACE CONSTRAIN OR WEIGHT LIMITATION COMBINED WITH THERMAL, VIBRATION OR SHOCK LOAD APPLICATION. AT TIMES HEAVIER LOAD THAN SPECIFIED VALUE ALSO CALLS FOR CUSTOMIZED DESIGN OF PLUMMER BLOCK HOUSING.

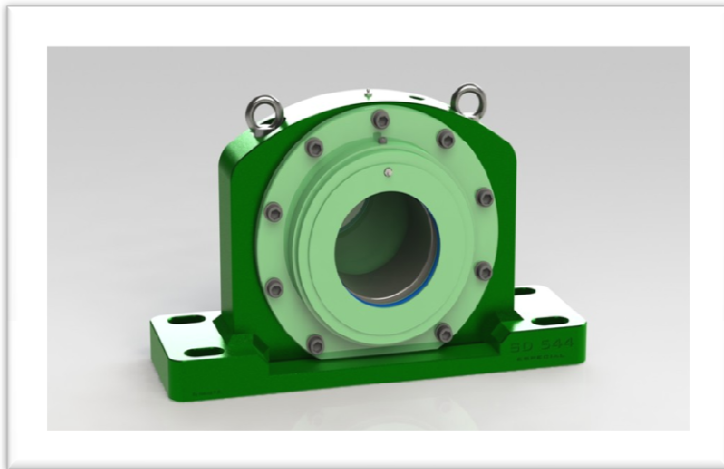

JAYCO HAS DEVELOPED AND SUPPLIED TAILOR MADE PLUMMER BLOCK HOUSING OF 2500 KG IN CAST STEEL TO BALL MILL AND STEEL PLANT. NUMEROUS SUCH PLUMMER BLOCKS ARE SUPPLIED TO STEEL ROLLING MILL AND IRON ORE MINE TO SUIT THEIR REQUIREMENTS. TEC HAS DEVELOPED SWIVELING CARTRIDGE HOUSING UNIT SUITABLE FOR COOPER BEARING FOR STEEL PLANT.

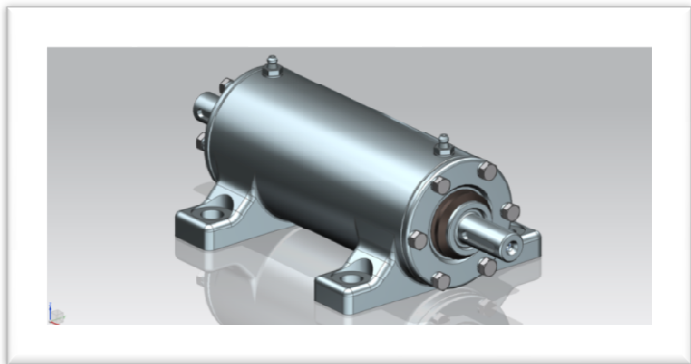
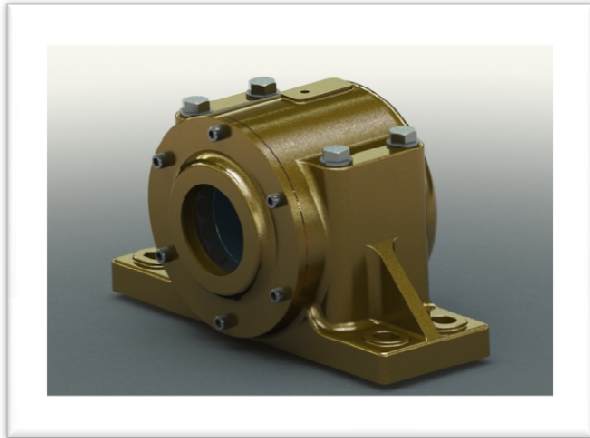

JAYCO HAVE BEEN CONCENTRATING FOR MANY YEARS FOR SUCH REQUIREMENT IN INDUSTRY AND HAVE DEVELOPED & SUPPLIED MANY TAILOR MADE PLUMMER BLOCK HOUSINGS. THE DEVELOPMENT PROCESS FOR SUCH HOUSINGS INCLUDES TOTAL INVOLVEMENT OF TECHNICAL EXPERTISE TO STUDY AND PREPARE PROPOSAL DESIGN AND DRAWINGS. THE CUSTOMER IS INVOLVED THROUGHOUT THE DEVELOPMENT STAGES SO THAT RESULTANT PRODUCT EXACTLY FITS TO THEIR NEED. SOME FEATURES ARE AS PER WHICH JAYCO HAVE SUPPLIES MANY PLUMMER BLOCKS ARE AS FOLLOWS:

1. CUSTOMER'S DRAWING
2. CUSTOMER'S TECHNICAL SPECIFICATIONS
3. SUBSTITUTE TO THE ONE USED BY CUSTOMER
4. REDESIGNED FROM WORN-OUT OR BROKEN PLUMMER BLOCK HOUSING LYING AT SITE
5. BEARING SIZE OR SHAFT DIA SPECIFIED BY CUSTOMER.

CUSTOMERS ARE ADVISED TO INCLUDE FOLLOWING DETAILS IN THEIR ENQUIRY FOR TAILOR MADE PLUMMER BLOCK HOUSING TO ENABLE US TO PREPARE OUR OFFER.

- 1.LOAD ON BEARING.
- 2.APPLICATION DETAILS.
- 3.ENVIRONMENT/SURROUNDING DETAILS.
- 4.PREFERENCE FOR TYPE OF LUBRICATION.
- 5.CONTINUOUS OR INTERMITTENT OPERATION.
- 6.SPACE AVAILABLE FOR MOUNTING.
- 7.CENTRE HEIGHT OF SHAFT/ BEARING.
- 8.R P M OF SHAFT.
- 9.TEMPERATURE AND VIBRATION CONDITION.



JOURNEY OF JAYCO

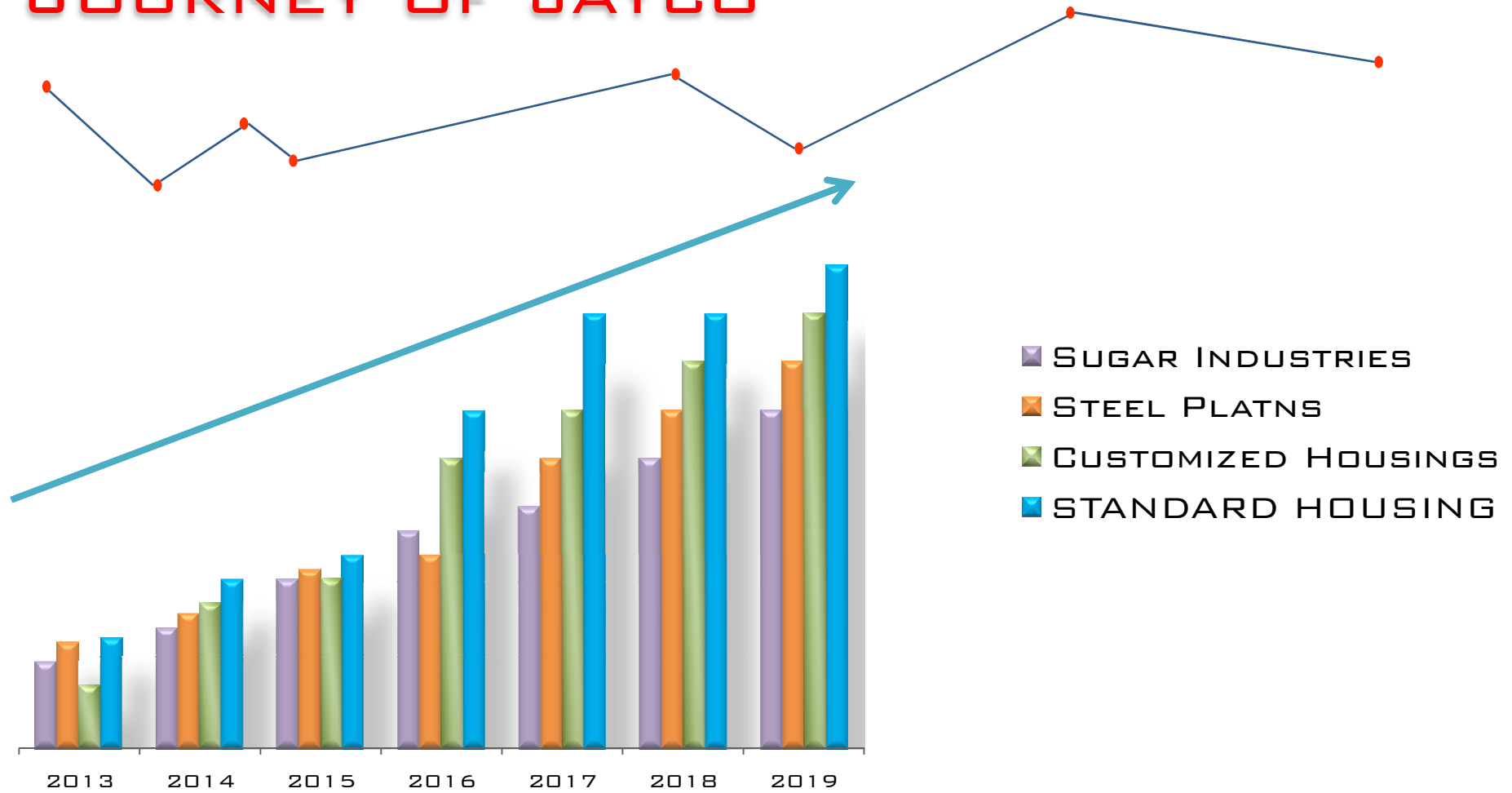

CLEAR BUSINESS FOCUS OF MARCHING TOWARDS
PROGRESS STEP BY STEP.



JAYCO -CORE VALUES (I-TREAT)

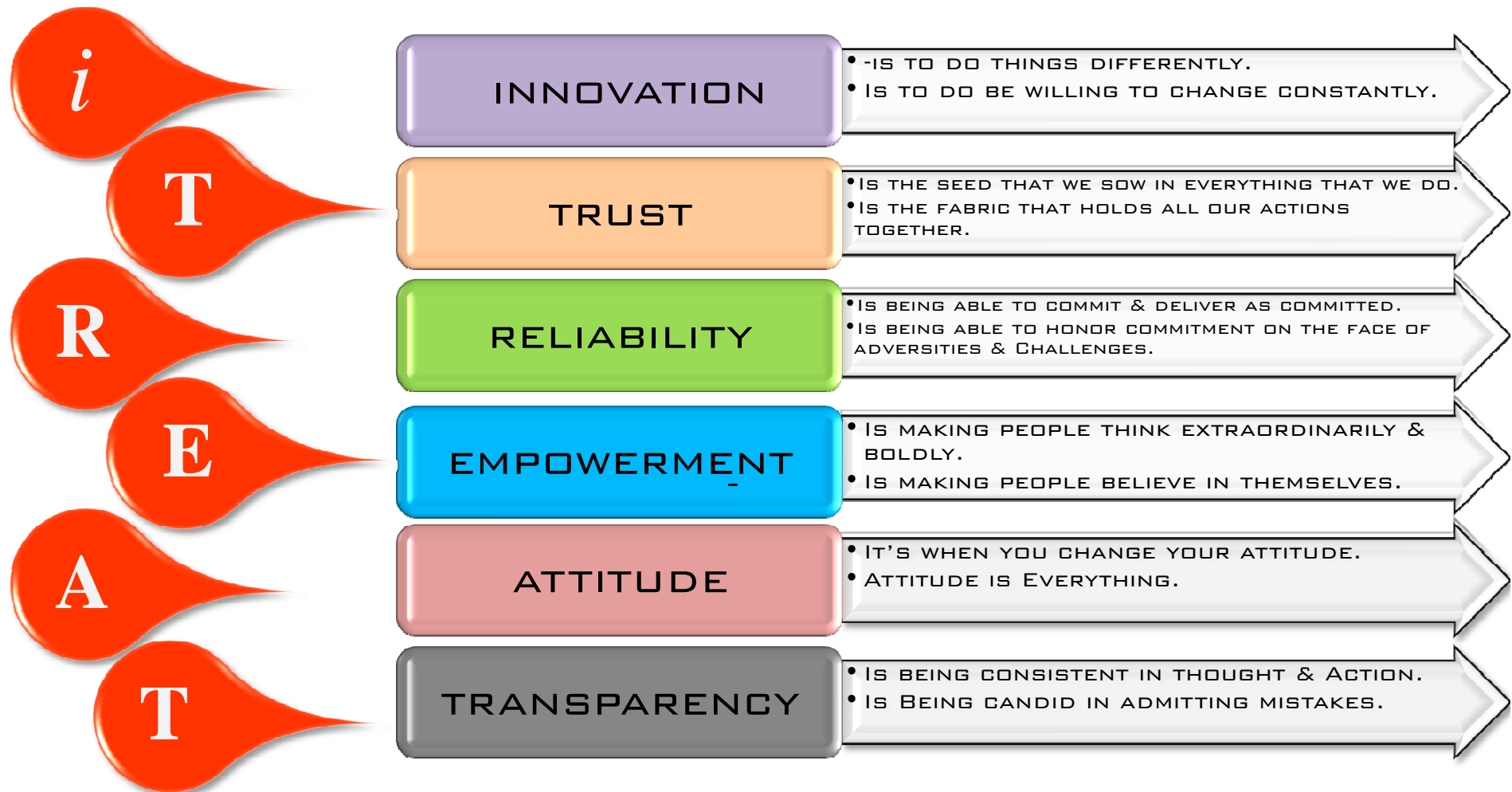

AT JAYCO, TREATING OUR PEOPLE & PARTNERS WITH RESPECT, DIGNITY AND COMPASSION IS A NATURAL WAY TO BUSINESS GOVERNANCE AND CONDUCT. OUR COMMITMENT WITH CONVICTION TO THIS PHILOSOPHY HAS LED US TO BUILD AN ENDURING ORGANIZATION, OUR VALUES ARE A REFLECTION OF THIS SPIRIT WHICH GIVES US OUR STRENGTH AND IDENTITY.

JAYCO - EXHIBITION



JAYCO PARTICIPATES IN EXHIBITIONS AND INDUSTRIAL FAIRS THROUGHOUT INDIA, AROUND THE YEAR IN PROMINENT LOCATIONS.

REPUTED CLIENT LIST



ADITYA BIRLA GROUP



JAYCO – CULTURE / SOCIAL RESPONSIBILITY.



GROUP TOUR (AMBAJI)



CHARITY –CANCER HOSPITAL



GET TOGETHER



GROUP TOUR KATRA (J&K)

APART FROM DEVELOPING & INTRODUCING ENVIRONMENT FRIENDLY AND ENERGY EFFICIENT PRODUCTS, AS A CORPORATE, WE ARE AWARE OF OUR SOCIAL RESPONSIBILITY. WE FEEL GRATEFUL TOWARDS THE SOCIETY AND INTEND TO GIVE BACK IN ANY FORM TO THE BEST OF OUR ABILITY. AS AN ENGINEERING COMPANY, OUR AIM IS TO USHER IN AN ALL INCLUSIVE GROWTH. TIME AND AGAIN

JAYCO®

ENGINEERING (INDIA)



OFFICE /WORKS

PLOT No. #252,
ROADNO.1,
G.I.D.C., KATHWADA,
ODHAV, AHMEDABAD- 382430.



WEBSITE:

WWW.JAYCOHOUSING.COM



EMAILS

INFO@JAYCOHOUSING.COM
JAYCOHOUSINGS@GMAIL.COM

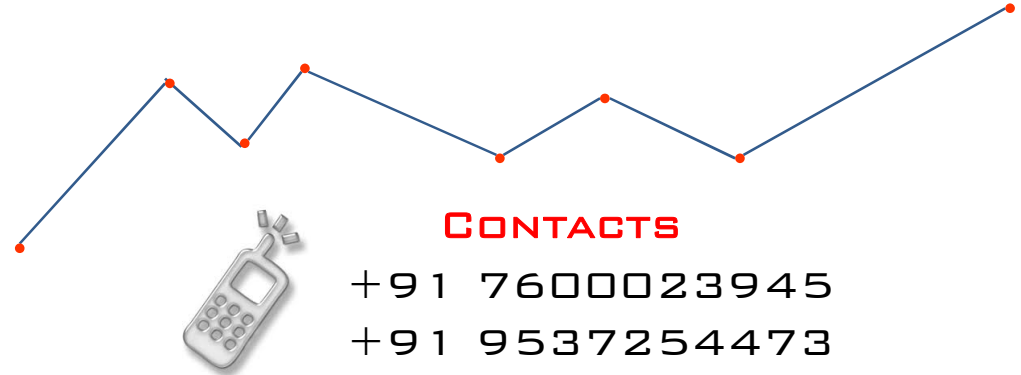

एक कदम स्वच्छता की ओर



MSME
सूक्ष्म लघु एवं मध्यम उद्यम
MICRO, SMALL & MEDIUM ENTERPRISES